

Georgia Southern University

Digital Commons@Georgia Southern

The George-Anne

Student Media

1-12-2016

The George-Anne

Georgia Southern University

Follow this and additional works at: <https://digitalcommons.georgiasouthern.edu/george-anne>



Part of the [Higher Education Commons](#)

Recommended Citation

Georgia Southern University, "The George-Anne" (2016). *The George-Anne*. 2905.
<https://digitalcommons.georgiasouthern.edu/george-anne/2905>

This newspaper is brought to you for free and open access by the Student Media at Digital Commons@Georgia Southern. It has been accepted for inclusion in The George-Anne by an authorized administrator of Digital Commons@Georgia Southern. For more information, please contact digitalcommons@georgiasouthern.edu.

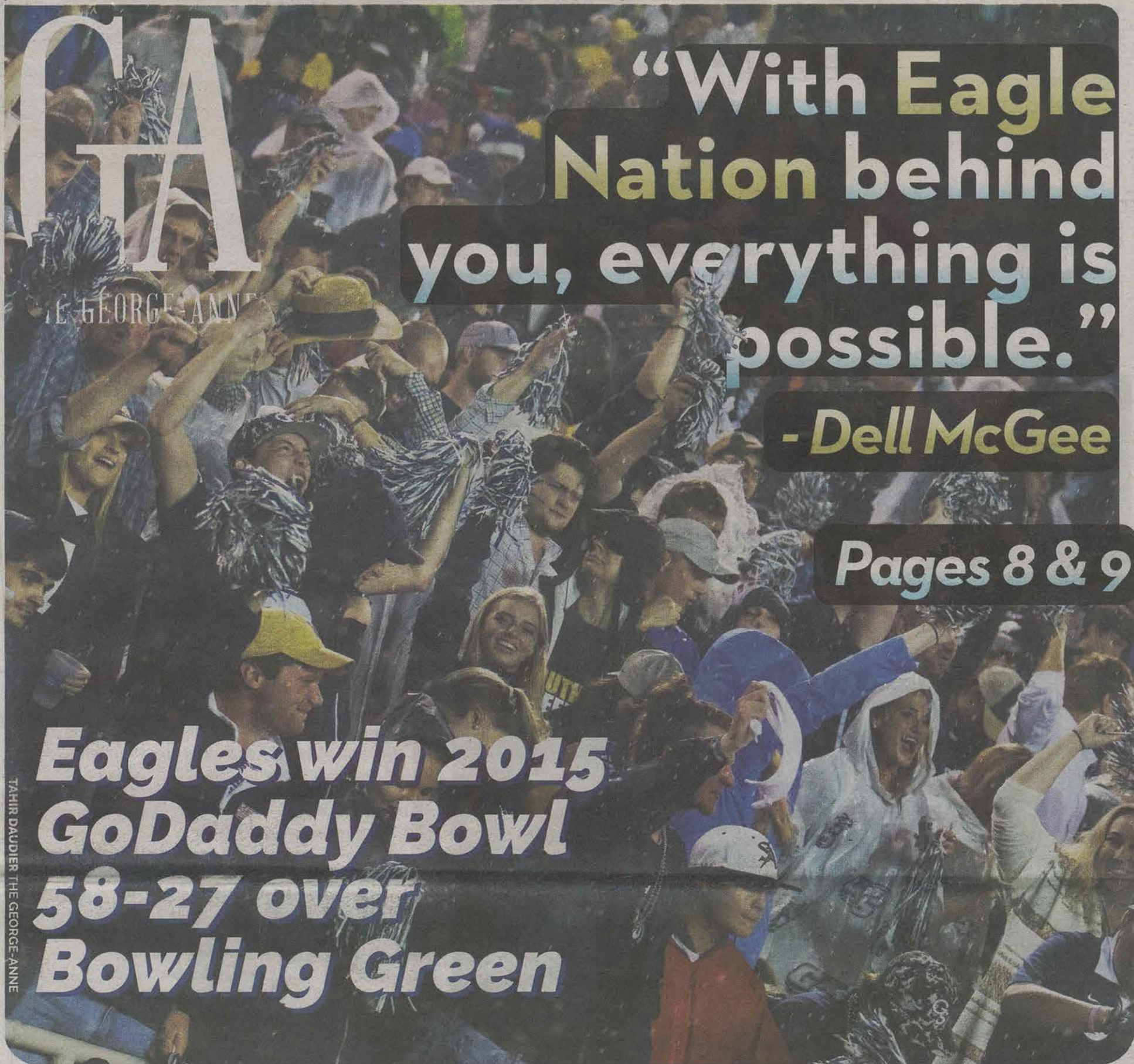

**“With Eagle
Nation behind
you, everything is
possible.”**

- Dell McGee

Pages 8 & 9

**Eagles win 2015
GoDaddy Bowl
58-27 over
Bowling Green**

TAHIR DAUDIER THE GEORGE-ANNE

NEW YEAR



**NEW HEALTH
CENTER**

Page 14

TAHIR DAUDIER THE GEORGE-ANNE



MICHAEL'S LAW
to impact Georgia
nightlife

Page 3

TAHIR DAUDIER THE GEORGE-ANNE

Tuesday Wednesday Thursday Friday



High: 58°
Low: 35°



High: 55°
Low: 32°



High: 62°
Low: 41°



High: 64°
Low: 53°



"THE BOOK PRICES ARE A PAIN IN MY MANE"

RÉSUMÉ BOOT CAMP

TUESDAY, JANUARY 12
DROP IN BETWEEN
1 - 5 P.M.

WILLIAMS CENTER
MULTIPURPOSE ROOM

REFRESHMENTS WILL BE AVAILABLE



GEORGIA
SOUTHERN
UNIVERSITY

OFFICE OF CAREER SERVICES

CONTACT THE OFFICE OF CAREER SERVICES AT
GeorgiaSouthern.edu/career 912-478-5197

f t u @gsucareers

FOREIGN TERRORS AFFECTING TRANSFER STUDENTS

by Devin Conway

Study abroad programs offer college students a chance to travel throughout foreign countries while simultaneously working toward the completion of their degrees.

Participation in these opportunities (particularly in the European region) amongst American students has become increasingly popular, with enrollment rates nearly tripling over the past 20 years.

Although these enlightening experiences certainly benefit students, there are inherent risks to be considered when traveling abroad, many of which can be attributed to the difficulty of cultural assimilation or simple cases of first time travelers being taken advantage of, but also because of an influx of terrorism, rape and other violent crime plaguing European societies.

Consider the following instances:

Paris, France is an extremely popular study abroad destination, but the capital city recently suffered from an organized terrorist attack that left **130 dead** and **368 wounded**, making it the most deadly attack in French history.

During a series of New Year's Eve celebrations, a group of **1000 men in Cologne, Germany** terrorized approximately **90 women** as they carried out threats, assaults, robberies and in some instances rapes.

In the past 10 years alone, **Sweden** has seen its sexual crime rates **nearly double**, which is statistically significant when considering the fact that rape cases in the country have **increased 1472%** in the past 40 years, giving it the **second highest rate of rape per capita in the entire world**.

Stay tuned to next week's paper for a deeper look at the violent crime epidemic found in formerly tourism-friendly regions of Europe and how it will affect the lives of European natives and travelers alike moving forward.

R REFLECTORGSU.COM
by Jamar A. Boyd, II

Faith, Humility & Optimism

"May your eyes look forward and your gaze be straight before you. May the path of your foot be balanced and all your ways be sure." - Proverbs 4:25-26

Life is a never ending journey and you never know what lies ahead. There will be trials and tribulations, joys and triumphs, pain and sorrow, the unexpected, the hope and prayed for and the undeniable and unworthy favor of God. The key in all things is to look forward.

See the full story on Reflectorgsu.com



PHOTO COURTESY REFLECTORGSU.COM

HAWTHORNE

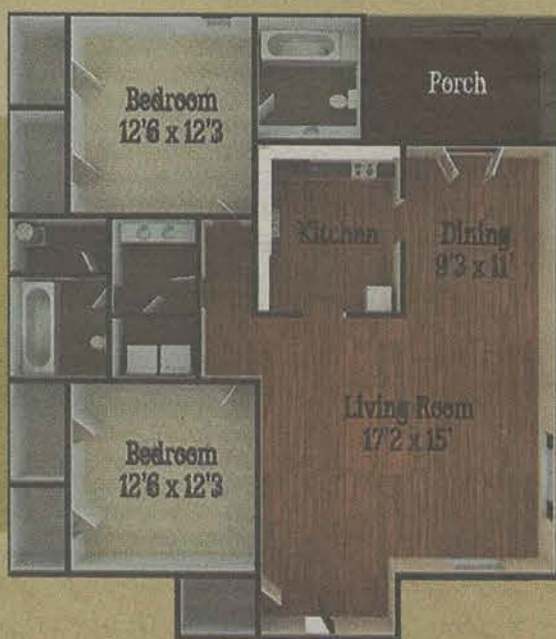

2 bedroom
flat

\$375
/month per person

www.hendleyproperties.com
912-681-1170

Puzzles

1-12-16

3

The George-Anne 1/12/16 Crossword PuzzleJunction.com

Across

- 1 Automobile sticker fig.
4 Farm area
7 Cattle members
12 "___ on my bed my limbs I lay": Coleridge
13 Flying formations
15 Gully
16 Slip into
17 "What ___ can I say?"
18 1996 Gibson, Russo thriller
19 Sign up
21 Peacock network
23 Compass pt.
24 Ten-percenter
25 Rubicon crosser
28 Official emissary
30 Dapper
34 Grayish
37 Bio bit
38 Extent
39 ___ few rounds
40 Wing it?
41 Drops on blades
42 Danger to divers
43 Covers
45 Neighbor of Ger.
46 Rope fiber
47 Summer TV offering
48 Spookily
50 Lean
52 Vacuous
56 Bishop's jurisdiction
59 Furrow
60 Organic fertilizer
61 Yellowstone sight
64 Clothes presser
66 Extinct flightless bird

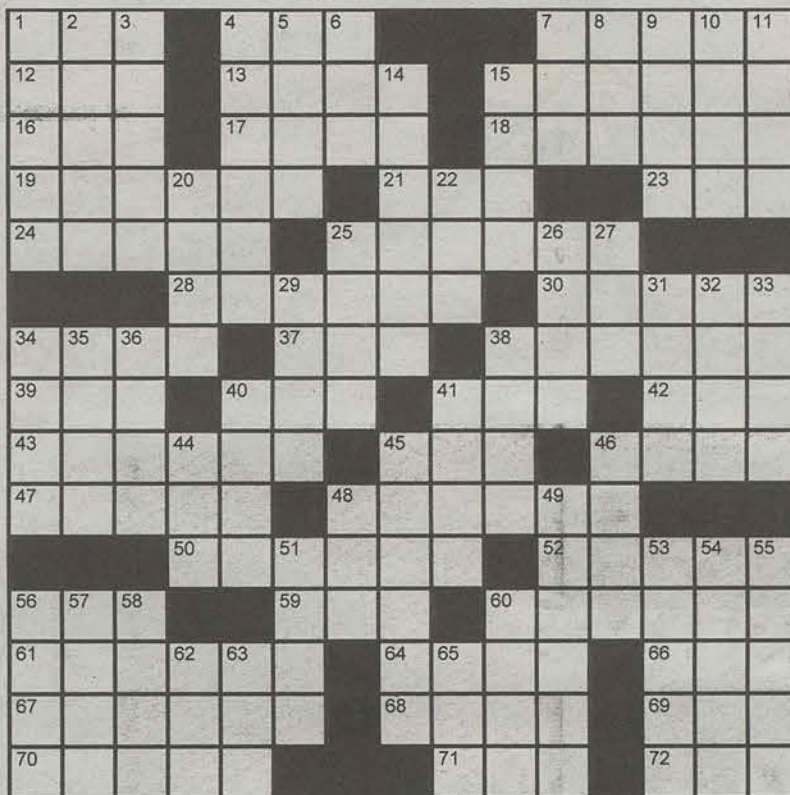

Copyright ©2016 PuzzleJunction.com

- 67 Gladiatorial sites
68 Kind of analysis
69 Abbr. in car ads
70 Astronaut John
71 D.D.E.'s command
72 Cambodian coin
10 City on the Rhone
11 A portion
14 Legislative body
15 Pendulum paths
20 Kind of child
22 Wax producer
25 Shrewd
26 From scratch
27 Sleazy paper
29 Misses
31 Arborist's concern
32 Abound
33 Puppy's cry
34 Gelatin substitute
35 Seafood selection
36 It'll grow on you
38 Pastrami purveyor
40 Informer
41 Small boat
44 Clear the tables
45 ___ ulcer
46 Song of praise
48 Down Under bird
49 Simple shelter
51 Camera diaphragm
53 Cougars
54 Figure of speech
55 Pine for
56 Ill-gotten gains
57 Viscount's superior
58 Fencing sword
60 Lion's share
62 Roadhouse
63 Crayola color
65 Fish eggs

Down

- 1 Princess of Colchis
2 Projecting part
3 Category
4 Sylphlike
5 Show's partner
6 Cry of success
7 Lingerie item
8 Ashes holder
9 Shake off

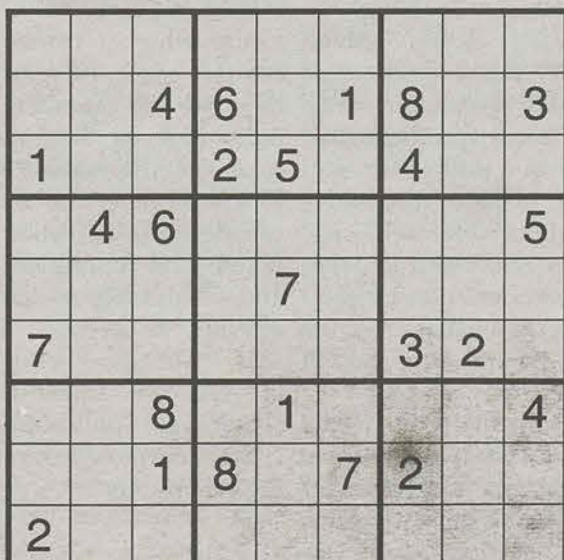
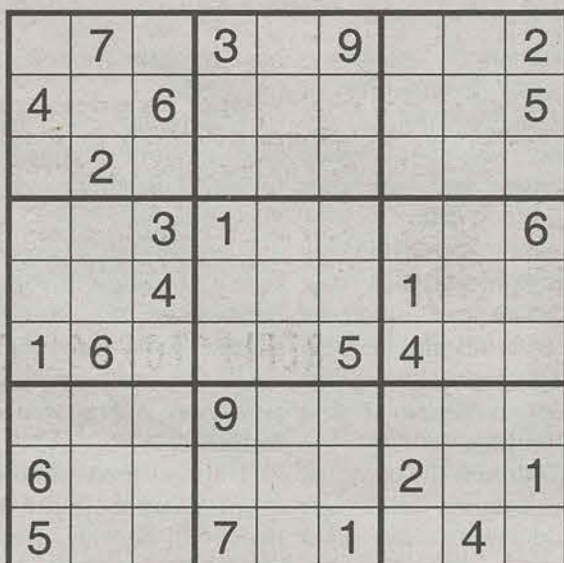

Student Support Services

Student Support Services (SSS) is a federally funded TRIO program through the U.S. Department of Education. The program provides comprehensive services to first-generation students, limited income students, and students with disabilities. The primary goal of SSS is to help transition, retain, and graduate college students.



Information Sessions:

Russell Union Room 2054

January 12	5:00pm
January 13	12:00pm
January 14	2:00pm
January 19	2:00pm
January 20	5:00pm

Learn more at our Information Sessions and apply at:

GeorgiaSouthern.edu/EOP



KELLY LOWERY | THE GEORGE-ANNE

PHOTO COMPOSIT OF HAILEY SMITH

Burglars are targeting off-campus complexes due to lack of security. Students can keep up with local crimes through social media and public service announcements.

Statesboro off-campus housing crime rate raises concerns

BY TANDRA SMITH
The George-Anne staff

The increase in off-campus crime incidents over the recent months in the areas surrounding Campus Crossings, Stadium Walk and Cambridge has resulted in students feeling unsafe at times.

"I do sometimes feel unsafe living where I stay because of the recent crimes that have occurred," Ashanti Hardy, junior justice studies major, said. "However, I believe that the same amount of crime probably happens in other areas around Statesboro that we are just unaware of."

It seems as if a robbery or some other offense occurs almost weekly and students are receiving Eagle Alert phone calls and texts at a more frequent rate.

Although students might believe that there is an increase in crimes around the area, the Statesboro Police Department states otherwise.

"We don't have any crime statistics that indicate an increase in crime for 2015," Justin Samples, Corporal of the Statesboro Police Department, said. "In fact, there has been a

decrease in crime."

Despite this, the department has stated that multiple complexes have expressed interests in keeping their property crime free, but this comes at a price.

One must consider the cost and time required to evict tenants causing problems, adding extra lighting and other security measures around the property as well as many other factors.

"A apartment complexes have a lot to handle on a day-to-day basis. Crime prevention isn't always on the top of the list," Samples said. "Managers have to consider 'quality versus

quantity' when it comes to residents would recognize someone that does not live in the area," Samples said. Maso Moon, a senior construction management major currently living at Campus Crossings, agrees with

As for who specifically targets these complexes, Samples declined to speculate,

but he did give insight into why off-campus complexes are chosen as crime targets.

"For would-be criminals, they see several potential targets in a small geographical area. It's easier to blend in while in an apartment complex as opposed to a neighborhood where

“I do sometimes feel unsafe living where I stay because of the recent crimes that have occurred,”

ASHANTI HARDY

junior justice studies major

Samples' statement.

"I feel like a majority of the crimes committed are by individuals who are locals of Statesboro and are not residents," Moon said.

Moon said that while his complex is tight knit and most students know each other, he still feels unsafe. He also hasn't seen a change in security measures around his complex.

"To down the complex with security and cops would make the area uncomfortable for students even though it's a safety reason," Moon said. "But I think there should be more than one security officer, that way one [officer] doesn't have to patrol the whole complex by himself."

The Statesboro Police Department uses targeted patrols in areas that they see increases in certain types of crime.

This is something that Danyl Dickerson, a sophomore mechanical engineering major and Southern Downs resident,

has recently noticed in his residence.

"I actually have seen an extra amount of cops show up to my apartment complex," Dickerson said.

Even though Dickerson has seen an increase in cop patrols, he believes that the complex should look into their own small security patrol team and more safeguards for the residents.

"I think there aren't many in my complex, but I do think there will be more [crimes] to come," Dickerson said.

It seems to be an uncertain future when it comes to off-campus crime. In spite of this, there are still measures that an individual can do on their own to prevent the increase of crime.

"The number one thing you can do is to lock your vehicle doors and apartment doors and always report suspicious activity to police," Samples said. "This goes back to the 'if you see something, say something' philosophy. The citizens are our eyes and ears in the community."

MICHAEL'S LAW TO CHANGE LANDSCAPE OF GEORGIA BAR SCENE

BY DEVIN CONWAY
The George-Anne staff

House Bill 152, which consists of a series of alcohol distribution regulations (most notably of which prevents persons under the age of 21 from entering any bar in the state) was signed by Governor Nathan Deal on May 5, 2015, and will be instituted state-wide on July 1, 2016.

Most commonly known as Michael's Law, in reference to Georgia Southern freshman Michael Gatto, who passed away following a violent altercation at Rude Rudy's on August of 2014, Bill 152 includes a lot of requirements that could affect business and students throughout Georgia.

Shortly after his death, Michael's parents Katherine and Michael Sr. learned that Rude Rudy's did not hold liquor liability insurance, which meant that the bar was not legally obligated to pay any of the costs associated with Michael's hospitalization or funeral expenses.

They later vowed to protect minors and to hold licensed distributors accountable by way of legislative action, leading the way to the implementation of

Michael's Law across the state.

The first section of the bill defines a 'bar' as any premises at which a retailer licensed to sell alcoholic beverages derives 75 percent or more of their total annual revenue from the sale of alcoholic beverages consumed on the premises.

This particular specification has major implications for local businesses that are slightly above or below that mark. Bars will either have to increase or maintain food revenues, respectively, in order to establish or solidify their status as a restaurant that serves alcohol rather than a bar that serves food.

In addition to the age restriction placed on patrons, bouncers and bartenders employed by a bar must also now be 21 or older. However, the age restrictions on patrons can be circumvented if the licensed distributor is hosting a live musical or performing arts event for which patrons have paid an admission price.

Section two outlines the process in which licensed alcohol distributors are responsible for self-reporting disciplinary action taken against the place of business to the Department of Revenue

within 45 days of the incident.

Businesses are subjected to any disciplinary action taken in response to a violation of a law or regulation by the licensed distributor or its employees. What are the consequences?

"If someone comes in with a fake ID that looks legit and says that they're 21, they become liable. Bartenders and staff get into trouble when someone comes in while lacking proper identification," Adam Justice, senior marketing major at Georgia Southern and bartender at Gnat's Landing, said.

An initial strike can result in a fine up to \$750.00. A second strike occurring within three years of the initial discipline may result in the suspension or revocation of a distributor's license.

"The strike system will force bar management and staff to follow these regulations because the consequences of not doing so are pretty severe," Michael Sapp, manager at Big Show's, said.

The bill concludes its proposals with a complete ban on the manufacture, possession, purchase or sale of powdered alcohol by civilians and licensed alcohol distributors alike.

BAR ENTRY LOOPHOLES FOR MINORS:

- Accompanied by parent or guardian
- Accompanied by spouse (someone 21 or older)
- Attending live concert/performing arts for which patron has paid admission

SHUTTLE GUS gets new rides

BY BAILEY ADCOCK
The George-Anne staff

Georgia Southern's Shuttle Gus program has received approval from the university's activity budget committee to purchase new vehicles. Still awaiting state approval, adding new cars would allow more students to take advantage of the program.

Shuttle Gus was originally started because of the need to prevent Southern students from driving under the influence. However, Shuttle Gus is available for any students that needs transportation regardless of the situation.

"I have used Shuttle Gus in the past. My car was not working and it was very helpful for me to be able to get around without having to pay an extreme amount for a taxi," Jordan Nourse, junior exercise science major, said.

Safety of students is one of the main concerns for the Student Government Association (SGA). As a result, the ability to provide a free and safe transportation service for the students has made Shuttle Gus a success.

"I think Shuttle Gus is such

a success with our students because it is free. It's a service that SGA provides students and there are no questions asked," SGA Senator KeShawn Harris, senior public relations major, said.

When members of SGA met to discuss their budget to find ways to save money, Shuttle Gus was one of the major issues brought up. SGA was spending about \$40,000 annually to rent cars for the Shuttle Gus program, excluding the cost of gas.

Purchasing cars for the program instead of renting them will be more economical not only for the organization, but also for the students at Georgia Southern University because Shuttle Gus is financed by student fees.

"Using student fees for student purposes is the best way to spend that money," Nick Johnson, sophomore mechanical engineering major, said.

According to GSU's student government page, this transportation service is run by student volunteers from organizations across campus.

"I've used Shuttle Gus as a freshman without a car and I've

used it with my organization," Ashley Mattison, senior multimedia communications major, said. "I love it and I'm so proud that we have been able to improve the program and get students home safe."

In addition to helping other students, each organization that volunteers receives \$300 which they can use for

themselves. However, there are some requirements.

There is a minimum of ten volunteers per organization, with at least four having to be 21 or older. Volunteers must operate during the already designated times of Shuttle Gus and they have to work all of the assigned hours.

If you are in need of Shuttle

Gus, their operating hours are from 10 p.m. to 2 a.m. and their contact number is 912-GSU-RIDE or 912-478-7433.

If your organization wants to volunteer for a weekend, you can email the Student Government Association at sga@georgiasouthern.edu, if you have questions or want more information.

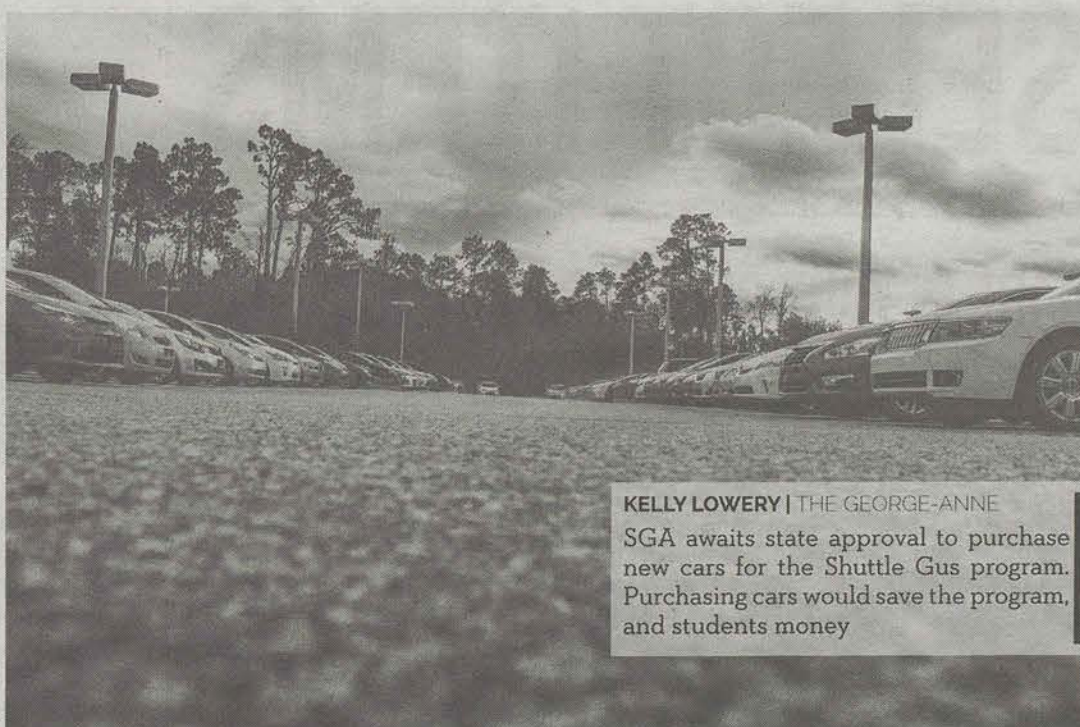

KELLY LOWERY | THE GEORGE-ANNE

SGA awaits state approval to purchase new cars for the Shuttle Gus program. Purchasing cars would save the program, and students money

WELCOME BACK SALE



b beats by dr. dre



Beats Solo2
Wired On-Ear
Headphones
Immerse yourself in an
emotional sound
experience. Engineered
for comfort.

SAVE BIG!
\$169⁹⁵

*Available to Georgia Southern Students,
Faculty, and Staff Only



The new iPad Pro
The latest and greatest
technology from Apple,
available to your favorite
Apple Authorized Retailer.

32 GIG 128 GIG 256 GIG

STARTING AT
\$779⁹⁵

*Available to Georgia Southern Students,
Faculty, and Staff Only

fitbit



Flex & Charge HR
Fitness trackers available
in a variety of colors.

STARTING AT
\$89⁹⁵

Cambridge Audio



A variety of devices
available at 20% off.
*iPod not included.

STARTING AT
\$115⁹⁵



kate spade
NEW YORK

Phone, tablet, and
laptop cases in a
variety of styles and
colors for 20% off.

STARTING AT
\$19⁹⁵



GoPro

Save with 20%
off accessories
when you
purchase a new
GoPro camera.

STARTING AT
\$129⁹⁵

10%, 20%, & 30% OFF SELECT ITEMS

TRADE IN YOUR OLD ELECTRONICS!

WE WILL BUY BACK YOUR WORKING OR DEFECTIVE SMARTPHONES, TABLETS, IPODS, AND MACBOOKS. IF YOUR DEVICE HAS NO VALUE, WE WILL RECYCLE IT AT NO CHARGE.

DON'T FORGET EVEN BIGGER SAVINGS!

WHEN YOU PURCHASE A COMPUTER FROM TECH CORNER YOU RECEIVE TWO COUPONS FOR FREE MAINTENANCE.

New solar-powered tables funded by student sustainability fees



KELLY LOWERY | THE GEORGE-ANNE

The panels allow students to charge their devices in an outdoor setting. The student sustainability fees are used to fund many sustainable projects around campus.

BY BLAKELEY BARTEE
The George-Anne staff

Outside the IT Building, four SolGreen Evodia Mini SmartTables—solar-powered patio tables with built-in charging stations—were installed this past December to provide an outdoor location for students to work and socialize while recharging their devices.

These SmartTables are equipped with four power outlets and four USB outlets, shut down automatically during rainstorms, can last five to seven days on stored power during overcast weather and contain LED lights for nighttime use.

Robert Lake, associate professor of Curriculum, Foundation and Reading, proposed the project and received a sustainability grant to fund the tables. The project's \$40,950 grant was funded by Student Sustainability Fees, which fund several sustainability projects proposed by students, faculty and staff every year.

"I felt that to have these solar panels would raise awareness of the possibilities of alternative sources of energy in a time where we need to start diversifying energy resources," Lake said. "We have a chance to make a difference."

One of the four tables is specifically designed to be wheelchair accessible, and the remaining three will generally accommodate wheelchairs as well, according to Lake.

Located in a high-traffic area and popular lunch spot, the SmartTables have already garnered attention from some students.

"I think it's a really good idea. I like that they added the coverage over them, too, to make that space more accessible and

more usable," Jessica Headrick, senior writing and linguistics major, said.

Lissa Legee, biology professor and director of the Center for Sustainability, noted the benefits of having the solar-powered tables on campus.

"You and I both know that our devices are always running out of power, and you need to be able to plug them in sometimes, and there's not always an easy place to do that, especially when you're outside," Legee said. "Now, you can sit and work at that table, plug in that laptop, plug in that iPhone or whatever it is you need to recharge, and you can enjoy being outdoors and charging that device at the same time."

While the tables benefit students and faculty, some difficulties were encountered during the installation of the tables.

"The tables and canopies did come in some very large wood crates that were a little challenging to move them (sic) from the warehouse to the CEIT building patio," James Grigg, director of Facilities Operation, said.

Legee feels that it's important for people to propose projects like the SmartTables, so the students fees can be used to assist student lives and be sustainable at the same time.

"I think having the student fee in place has really opened the door for our campus to improve in sustainability by leaps and bounds. Because anybody with a good idea can apply to get those funds," Legee said. "Now, there's this great mechanism by which we can actually allocate funds to reduce our ecological footprint and become a greener campus."



TIMELINE OF EVENTS FROM MOBILE PAGES 8 & 9

TAHIR DAUDIER THE GEORGE-ANNE
Jamal Johnson reacts to another big play from the defense. The Eagles defeated Bowling Green 58-27 in their first bowl game in the program's history.

EAGLES TRAVEL TO DUKE

PICK UP THREE
WINS OVER THE
BREAK

BY HAYDEN BOUDREAUX &
MARQUS WILLIAMS
The George Anne staff

DUKE

While most students made the trip home after finals week, the Georgia Southern men's basketball team went on a different kind of road trip to face off against the defending national champions, the Duke Blue Devils. The Eagles were able to hang around at the beginning but ultimately fell, 99-65.

The Eagles opened the game with a quick defensive rebound, a steal, and a layup to grab the first points of the game. Tookie Brown led the team with 20 points, four assists and two steals.

Ultimately, the size and athleticism

of Duke was too much for the Eagles to overcome. The game was a great learning experience for Georgia Southern, as Duke is likely the best team they will face all season.

"I wanted our guys to see their culture. How hard (Duke) played kind of knocked us on our heels. When they missed the shot, they went and got it. That's a championship culture," Coach Byington said following the game.

"Yeah we had butterflies in us at first but we played good at the beginning," Brown said about playing in Cameron Indoor. "We started giving up on balls towards the end of the game though. It's a learning experience."

MEN'S BASKETBALL
cont. on page 10

WOMEN'S BASKETBALL EARNs FIRST SUN BELT VICTORY

The team stayed busy over the break, competing in eight games. The Eagles picked up two wins, including their first conference victory.

BY CHRIS SMITH
The George Anne staff

During the break Georgia Southern went 2-6 with both wins coming at home. Georgia Southern opened up the break with a 64-51 win over Charleston Southern, but then suffered a 5-game skid before defeating conference foe South Alabama 57-43 on Thursday.

The Eagles were 0-4 away from home losing to Stetson, Bethune-Cookman, Texas State and UT Arlington. Southern went 2-2 at home defeating Charleston Southern and South Alabama, but losing to Robert Morris and Troy.

Junior guard Angel McGowan

tied her season high in points scoring 26 in Southern's win over South Alabama and making five shots from three-point range. She continued her hot shooting after she scored 23 points against Troy including four buckets from long range. McGowan has averaged 15.9 points per game over the last eight games. Junior forward Patrice Butler has added to that, averaging 14 points per game during this span. Senior forward Briana Jones has seen a steady decrease in her minutes over the break. Jones has been shutout in four of the last seven games and she is looking to turn it around against the Eagle's upcoming conference opponents.

WOMEN'S BASKETBALL
cont. on page 10

'IS Godaddy BOWT

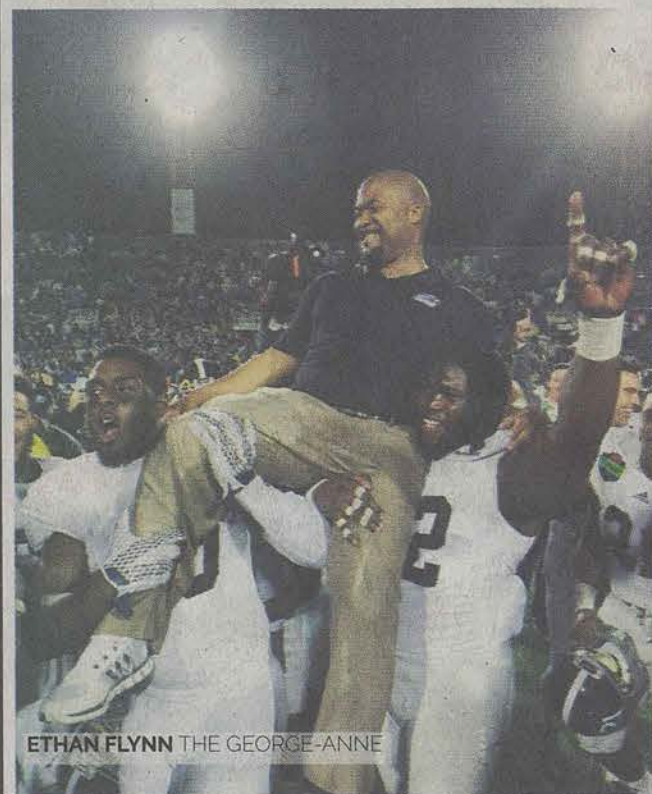

ETHAN FLYNN THE GEORGE-ANNE



The Eagles ran for 452 yards and seven touchdowns on the ground.

Favian Upshaw led the way with 199 rushing yards and four rushing touchdowns. He was named MVP of the game.

Matt Dobson returned a blocked extra point attempt for two points. He went on to win Special Teams Player of the Game.

Caleb Williams had three tackles and five break ups in the game.

Eagle Nation celebrates the win on the field.

Dell McGee is carried onto the field by the players to celebrate.

VL CHAMPIONS

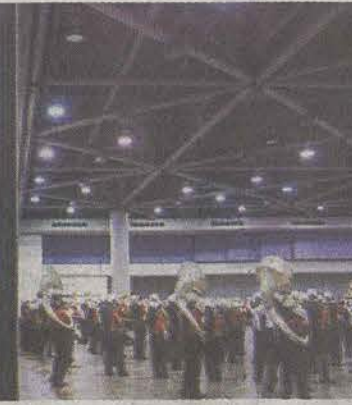

Historic weekend in Mobile

Tues. Dec. 22, 6:30 p.m.: Fans of both schools are treated to a pep rally the night before the game.

Cheerleaders, mascots and the bands put on performances for the fans.

Wed. Dec. 23, 4:30 p.m.: The team arrives in style in the famous yellow school buses for the Eagle Walk.

7:00 p.m.: The Eagles kicked off the 2015 GoDaddy Bowl.

8:45 p.m.: After trailing 27-23 at halftime, the Eagles poured on 35 points in the second half, cruising to a 58-27 victory.

10:30 p.m.: Eagles win first ever bowl game, beating Bowling Green 58-27.

MEN'S BASKETBALL

CONTINUED FROM PAGE 7

The all time winningest coach in college basketball had some compliments on the Eagles and Brown's performance.

"He's a good player," Duke head coach Mike Krzyzewski said about Brown. "I think he's their most poised player. As a freshman, he ran his team well. He just adds stability. I thought he had really good poise, and he never got tired."

NON-CONFERENCE SLATE

The Eagles finished up the non-conference schedule by splitting a pair of home games. They fell to Winthrop 88-81 and defeated Stetson 75-58. Tookie Brown scored 20-plus points in both games. The Eagles had one of their best defensive efforts all season against Stetson, forcing 18 turnovers and 11 steals while scoring 13 points off turnovers.

SUN BELT WOES

The Eagles dropped the first three games of the Sun Belt to Texas State, UT Arlington and South Alabama. The offense sputtered in the three-game stretch, averaging 65 points, a number way below their season average. They also turned the ball over more than usual which led to the losses. Coach Byington said that the team stayed focused and didn't get discouraged by the losses.

"We got a vision of where we want this thing to go," Byington said. "The losses take a lot out of you. I want the guys to understand that if they do everything right, we're gonna win more."

FIRST SUN BELT WIN

The Eagles hung on in overtime to get their first Sun Belt Conference win against the Troy Trojans 93-88. The

Eagles offense had one of its best performances all season as they shot 53 percent from the floor and 32 percent from long range. Sophomore Jake Allsmiller sparked the Eagles by hitting three 3 pointers in the first four minutes of the game giving the Eagles more confidence in their offense for the game.

The team combined for 44 points in the paint as multiple players contributed to the effort as they keyed in on passing the ball around to create open shots with sophomore, Mike Hughes, led the way with 22 points. "We just knew we had to go out there and do whatever we needed to do to win," Hughes said.

Tookie Brown, Jake Allsmiller and Ike Smith each made a big impact in the game scoring 19, 16 and 16 points respectively, giving their team the balance they



BRANDON WARNOCK | THE GEORGE-ANNE
The Eagles went 2-5 over the break. They will play again this Thursday at home against UL Lafayette.

needed in the game.

"I'm really proud of the fact they fought and they did not give in. Tookie Brown made some big plays and Ike Smith, Jake, and Mike without Montae Glenn, a lot of guys came in mixing and matching the lineup and we're glad the result came out for our

guys" Byington said. The win moved the Eagles to a 17-4 home record in their last 21 contests. They'll prepare for a two game home stand starting Thursday against Louisiana-Lafayette at 7:30 p.m.

WOMEN'S BASKETBALL

CONTINUED FROM PAGE 7

After Georgia Southern received their first conference win of the season against South Alabama head coach Kip Drown was excited because it was his very first Sun Belt win.

"I'm really happy for our club because we needed to get that win to stay in contention. It's always nice to get those things out the way and move on," Drown said.

Southern has seen some inconsistent play as of late when it comes to competing

and they are trying to find ways to change their fortune.

"I told our team after the game at Texas Arlington last week that until we learn to compete and go nose-to-nose with people, the Xs and Os really don't matter. I felt like we went nose to nose with them today, and I feel encouraged by that," Drown said.

The Georgia Southern women's basketball team is slowly sliding down standings in the Sun Belt conference and need to capture a few more wins against their conference

opponents in the upcoming games. The Eagles have a 1-3 conference record and are currently 10th in the Sun Belt.

Next up Georgia Southern has a contest at home against conference opponent UL Lafayette. This is a blue out game, so fans are encouraged to wear their blue attire. The broadcast of this game will be live on ESPN 3 and the students and fans will meet the new football head coach Tyson Summers.

Interns Wanted

Build your resume with our
**PAID POSITIONS for
SALES/ACCOUNT EXECUTIVES**

Walk-In Interviews:
January 18, 19, 20
9 a.m. - 2 p.m.
Williams Center RM 2016
Bring Your Resume.

- All majors are accepted.
- No experience is necessary.

**STUDENT LED
STUDENT MEDIA
STUDENT READ**



MADISON REYNOLDS | THE GEORGE-ANNE
The Eagles picked up their first Sun Belt victory of the season over South Alabama on Jan. 7. Angel McGowan leads the team in scoring with 15.3 points per game.

INTRAMURAL SPORTS ARCHERY

ONLINE REGISTRATION:
JANUARY 11 -
JANUARY 26

MATCHES HELD:
WEDNESDAYS OR THURSDAYS
FROM 8:00PM - 9:30PM

REGISTRATION FEE:
\$30 PER TEAM

PLAY BEGINS:
FEBRUARY 3

TEAMS OF 4 - NO EXPERIENCE NECESSARY
REGISTRATION FEE COVERS ALL EQUIPMENT

REGISTER AT GEORGIASouthern.EDU/INTRAMURALS

INTRAMURAL SPORTS BASKETBALL

ONLINE REGISTRATION: PLAY BEGINS:
JANUARY 4-19 JANUARY 24
REGISTER AT RECREATION.GEORGIASouthern.EDU/INTRAMURALS

Find your #RACLIFE

TEAM UP

CRI
Campus Recreation
& Intramurals
GeorgiaSouthern.edu/cri



Want some help keeping your New Year's resolution? Then cut along the dotted line and save this schedule; we'll make sure you have the motivation you need to stay in shape and have some fun along the way!

SPRING 2016

Get Fit. Get Group Fit.

	MONDAY	TUESDAY	WEDNESDAY	THURSDAY	FRIDAY	SATURDAY	SUNDAY
7:00-8:00	CYCLE 45	MORNING YOGA	MORNING YOGA	CYCLE 45	MORNING YOGA		
8:30-9:30						CYCLE 60	
10:00-11:00						VINYASA YOGA	
12:15-1:00	PILATES		CYCLE 45	VINYASA YOGA	CYCLE 45		
5:30-6:25	CARDIO KICKBOXING	TOTAL BODY BLAST	ZUMBA	HIP HOP JAM	H.I.T. FIT		
	CYCLE & CORE	CYCLE 60	CYCLE BOOT CAMP	CYCLE & TONE			
	VINYASA YOGA	VINYASA YOGA	PILATES	POWER YOGA	YIN YOGA		
	AQUA ZUMBA			BARRE & TONE			
6:05-7:00	SB BOOTCAMP	SB BOOTCAMP	SB BOOTCAMP	SB BOOTCAMP			CYCLE & CORE
	BARRE & TONE	INSTRUCTIONAL DANCE					
6:35-6:55	AWESOME ABS	AWESOME ABS	AWESOME ABS	AWESOME ABS	AWESOME ABS		AWESOME ABS
7:05-8:00	HIP HOP JAM	ZUMBA	CARDIO KICKBOXING	H.I.T. FIT			HIP HOP JAM
	CYCLE 60	CYCLE & TONE	CYCLE 60	CYCLE & CORE			VIN YOGA
	YOGA & MEDITATION	PILATES	VINYASA YOGA	VINYASA YOGA			
8:05-8:25	AWESOME ABS	AWESOME ABS	AWESOME ABS				
8:30-9:15	TOTAL BODY BLAST	YOGA ABS	HIP HOP JAM				

MULTIPURPOSE ROOM

MIND AND BODY STUDIO

AQUATICS/POOL

SPINNING STUDIO

GROUP FITNESS ROOM

STUDIO 2

YES, THAT IS YOUR ALARM.



SKYLER BLACK

Black is a senior writing and linguistics major from Warner Robins, Ga.

It's a great Monday morning at your home while you sip on coffee and slowly eat your breakfast. Your parents are off at work and you are watching whatever garbage television is on this early in the morning but there is something not quite right. What is that sound? That loud, repeated buzzing that is bouncing around the walls of your bedroom. Yeah, that's your alarm going off at seven in the morning. It's the first day back from winter break and you have an 8:00 a.m. You have that major headache from waking up three hours after you fell asleep that morning.

Coming back to school after having the freedom to make your own schedule for a month is an extremely difficult endeavor. Your classes have changed, the temperature has dipped dramatically and you

have to wake up even earlier than last semester. Even your opinions editor has changed! The first week of classes is always the most annoying since you have to be in every class. Syllabus week is when you and the students around you get to figure out just how much work you will be saving until the last minute.

Trying to transition back into a schedule with upwards of 15 hours of classes, along with part-time jobs and internships, after being free to coast through the month of December can bring a great strain on your stress level. I am not one of those people that can seamlessly fit back into a system. My approach to a new semester has been the same since Fall 2012. The first few weeks I stay conscious in my courses, just enough to get the attendance credit. Then, as assignment deadlines start to inch closer, I write them down in a notebook that I will forget about. Finally, as I am a few days from my deadlines, I begin the assignments and finish work, which should be done in a week, in two days.

This semester, at least for

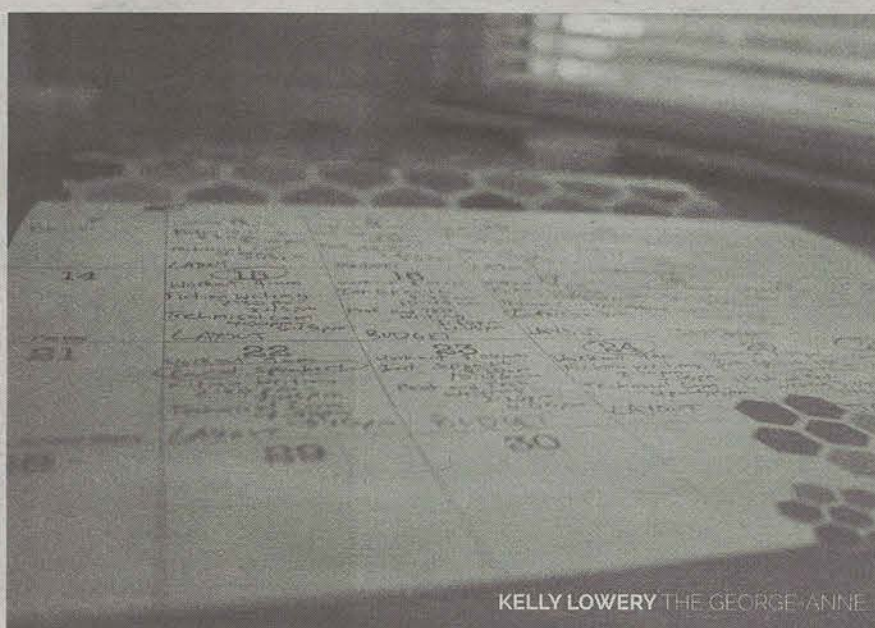

KELLY LOWERY THE GEORGE-ANNE

the first two weeks, each of us will be setting three or four alarms to ensure that we actually wake up, printing our schedule out and putting it in the front of binders, and saving our classes into our phone calendar. I suggest that we all do something different this semester. What that something might be, is entirely up to you but I believe that this year something needs to change. My personal plan is to establish a routine early on in the first week of classes. That means waking up early to make breakfast, workout, study or whatever the case may be.

The major issue, I think, that is killing us as students coming back is not establishing long-term goals at the beginning of the semester. This has a massive impact on how

quickly you can get back into the swing of things on campus. By setting goals, you are telling yourself that you are going to ensure that you have better attendance, get better grades, and make a positive impact on campus.

As students, we all know the struggle of leaving the comfort of our beds to endure the ever changing weather that plagues Statesboro. With the weather dropping to near freezing temperatures, it is hard to find any drive to get back on track with classes. But what we should always remember when we look at ourselves in the mirror in the morning is #newyearnewme. Bundle up Eagles, it's gonna be a long one.

Microtransactions: a simple solution



DJ FULLMER

Fullmer is a sophomore multimedia film and production major from Richmond Hill, Ga.

Today's word of the day is "microaggression," which is a very simple term for when someone makes an offhanded comment toward you, whether it be about your race, sex, or appearance. Examples include

being handed ranch instead of the desired salad dressing you wanted, an off handed compliment that may be too specific, or just a random comment that makes you feel a certain type of way. Now, these injustices must be stopped, and the only logical solution is to implement a payment mechanism for the people having the comments made toward them.

There should be a small fee transferred between the two parties in order to show that the person has hurt the other, except the one "offended" should be the one paying. The aggressor is the true victim when they are called out for these "microattacks." How is it fair for one person to attack another human being for making a comment not totally thought out? So there needs to be money exchanged

between the two individuals in order for the aggressor to be compensated for the social atrocities that are now inflicted on their lives. If it is a one time occurrence, it is simply a \$0.99 exchange through various apps like VenMo, SnapChat, and Facebook Messenger. However, if the commentator continues to berate anyone that dares come at them with a statement that could be perceived in any way racist, sexist, classist, and/or ableist (all of which are very serious issues). They will be required to start a monthly fee of \$8.99 in order to save their bank account the trouble of being overdrawn.

An alternate solution to this payment is not to be offended by every little comment toward one's ethnicity on a day to day basis. Micro-aggression focuses on the itty bitty comments towards a person or their

children. There are many cases of very serious instances of microaggression, except, that is not microaggression. That is called racism. There is nothing micro about asking a Latino if they are legal or not, that's just racist. However our millennial generation has decided to create a term for any type of phrase that could be pertained offensive in any light. So now we have two options either learn to be more easy going or start paying these microtransactions in order for these victims to learn how they are affecting everyone's lives.

I will be part of this solution as well, since I'm just an Irish white kid named Darrell, Darrel, Daryl? It doesn't matter because I definitely have never walked into a room and had someone tell me they were expecting a very different person.

STATEMENT OF OPERATIONS

The George-Anne is the official student newspaper of Georgia Southern University, operated by GSU students using facilities provided by the university. The newspaper is the oldest continuously published newspaper in Bulloch County.

The newspaper is published twice weekly, on Tuesdays and Thursdays, during most of the academic year. Any questions regarding content should be directed to the student editor by phone at 912.478.5246 or at gaeditor@georgiasouthern.edu.

ADVERTISING: The newspaper accepts advertising. Inquiries may be made by calling 912.478.5418 or 912.478.0566. For questions e-mail ads1@georgiasouthern.edu.

The George-Anne receives additional support in part from the Student Activities Budget Committee. For more information, rate cards, or sample publications, contact the advertising manager or student media director. The advertiser is responsible for any errors in advertisements and its liability for adjustments is limited to the amount of space the error occupied in the ad. Further, the newspaper is not responsible for any damages caused due to an ad's omission from a particular edition and its responsibility solely is to reschedule the ad in the next regular edition at the regular advertising rates.

STUDENTS BEWARE: The George-Anne screens all advertisements prior to publication. The newspaper strives to accept ads for legitimate products and services only. Students are urged to exercise caution when replying to ads-- particularly those that require personal information. Students are also urged to report to the newspaper any suspicious offers which they might see in an ad.

PUBLICATION INFORMATION: The newspaper is printed by The Brunswick News in Brunswick, Ga.

NOTICE: Unauthorized removal of multiple copies from a distribution site constitutes theft under Georgia law, a misdemeanor offense punishable by a fine and/or jail time.

CORRECTIONS: Contact the editor at gaeditor@georgiasouthern.edu for corrections and errors.

STAFF LIST

Editor-in-Chief Lauren Gorla
Managing Editor Ian Leonard
Content Strategist Casey Cargle
News Editor Jozeph Papp
Features Editor Meg Elwood
Sports Editor Robert George
Daily Editor DJ Fullmer
Opinions Editor Skyler Black

Creative Manager Hailey Smith
Photo Editor Brandon Warnock
Design Editor Alex Smith
Features Designer Rebecca Davis
News Designer Margarita Suarez
Sports Designer Erin Fortenberry
Opinions Designer Margarita Suarez
Distribution Manager Andrew McCarthy
Marketing Manager Cydney Long
Business Manager Taylor Norman

The George-Anne welcomes letters to the editor and appropriate guest columns. All copy submitted should be 350 words or fewer, typed, and sent via email in Microsoft Word (.doc/.docx) format to letters@georgiasouthern.edu. All submissions must be signed and include phone number for verification. GSU students should include their academic major, year and hometown. The editors reserve the right to reject any submission and edit submissions for length. Opinions expressed herein are those of the Board of Opinions, or columnists themselves and DO NOT necessarily reflect those of the faculty, staff, or administration of GSU, the Student Media Advisory, Student Media or the University System of Georgia.

MEET THE STAFF: FEATURING THE FEATURES

BY MEG ELWOOD
The George-Anne staff



MEG ELWOOD

Features Editor
junior journalism major

"I see how far I walk each day on my UP band and take an hour to chop ingredients when I cook. 'South Park' then 'The Daily Show with Trevor Noah' and a hot cup of tea at 11:00 p.m. Simple? Sure. Boring? Never."



KAT SHUMAN

Assistant Editor
sophomore English major
"Aspiring Kardashian, fan of the Oxford comma and advocate of child leashes. I walk backwards as a Southern Ambassador, #LeadAndServe with the OLCE and I'll be SOARing this summer. Jesus Lover. Somewhere watching Downton Abbey. Sentence fragments. Queen of hyperbole."



ARAYA JACKSON

Staff Reporter
sophomore journalism major
"Just your average sassy mouth gal with a keen taste for wine and chicken fries, who's just trying to write a good story and possibly get her life together."

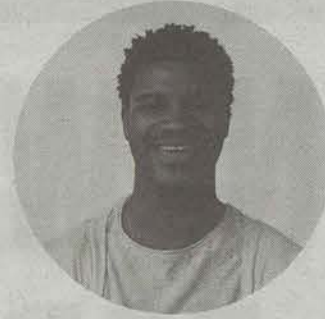

RICKY VEASLEY

Staff Reporter
senior journalism major
"HEY YOU! Yeah you, the one reading this. I have a huge confession I have to tell someone. Of all the things I've lost, it's my mind that I miss the most. If you didn't know, I'm the star of my own reality TV show called Life. It's quite entertaining so you should tune in. It's full of cliffhangers that..."



RACHEL KELSO

Staff Reporter
sophomore journalism major
"Hey readers! Hopefully you'll be seeing me on CNN one day. Writing, traveling, and experimenting with makeup takes up most of my time, except for when I'm on Netflix binge-watching The Office for the hundredth time."



ASHLEE GILLEY

Staff Reporter
junior journalism major
"I live by the phrase 'do whatever you have to do to be happy'. You can never go wrong with Chinese food and a scary movie. I enjoy video games and they enjoy making me angry. Writing, animals, and music are all important to me."



REBECCA DAVIS

Page Designer
senior graphic design major
"Hey y'all! I am 21 years old and a complete mess. I am graduating in the spring hoping to find work in anything ranging from magazine publication to redesigning for a major league sports team. In my spare time, you can find me drinking wine and watching Vanderpump Rules on my couch every Monday."



TAHIR DAUDIER

Photographer
senior film and production major
"Telling stories and spreading love and knowledge is my ultimate calling to this planet and it's people. Through forms of media like radio, photography and filmmaking, I have seen the intimacy between media and society. Composing thoroughly designed communication platforms, in representation of my family, friends and dedication to study is very important to me."

WHAT TO SEE IN 2016

BY MEG ELWOOD
The George-Anne staff

Hello humans of Georgia Southern!

Welcome to the 2016 Features section. Featuring life as we know it.

This semester, look forward to being a part of stories, as well as reading them.

- Take part in our Advice Column. Message us on Twitter @GeorgeAnneFeats and your question may be featured in Thursday's new biweekly piece.

- Experience our stories on Snapchat. Look for our QR code and get an enriched experience on select stories.

- Pin us on Pinterest. All of our DIY's, fashion, beauty, and cooking tips will now be featured on our Pinterest page. Follow "GeorgeAnne Features" to start making beautiful things.

- The Buzz List returns! The tradition continues this semester every other Thursday so you'll never be out of the loop.



TAHIR DAUDIER THE GEORGE-ANNE

NEW YEAR, NEW LOCATION FOR THE HEALTH CENTER

BY RICKY VEASLEY
The George-Anne staff

Health Services is now located on 984 Plant Drive, directly across from the Performing Arts Center. Students can begin going to Health Services building on Monday, Jan. 11.

The new Health Services building, 39,000 square feet, took almost a year to build and cost 8.9 million dollars. It was built by Collins Cooper Carusi Architects and Juno.

The first floor houses the Pharmacy, Injection Clinic, Eagle Eye Care, General Medical Clinic and the Lab. The second floor houses Administration, Physical Therapy, Health Education and Women's Health.

The new pharmacy will have over-the-counter medicine and since it is 10 times bigger than the old pharmacy, students and faculty will soon be able to get their prescription filled at the pharmacy without going to other places like CVS and Walmart.

In March, students will be able to use their insurance in the pharmacy.

"My goals are to meet the needs of students, grow and broaden services," Russell Bozeman, Pharmacy Manager said.

Eagle Eye Care was previously located in Centennial Place, but many students were unaware of their location. Eagle Eye Care can fill most prescriptions for glasses and contact lenses, adjust and repair frames and conduct eye exams.

"I think the location is better for the students. We'll have a lot more traffic coming through. Right now we don't have a doctor, but we're working on that. It'll be a while before we are a full eye-care facility," Candice Thompson, Licensed Dispensing Optician said.

General Medical clinic is where students come in for common problems, like colds, high blood pressure and diabetes. "Everything is pretty much the same routine for students, but we're trying to make sure we are consistent," Stacy Lucas, Certified Medical Assistant said.

The injection clinic has two rooms where they issue injections. There is a large freezer that holds injection and immunization serums.

"We do immunization compliance, allergy shots, chickenpox and QuantiFERONs," Deltrye Jackson, Certified Medical Assistant said.

The Radiology lab has a remote controlled x-ray machine that moves to accommodate the area in which students are getting x-rayed.

"We cater to our students and take care of all their needs, that's what we're here for. We have a whole lot more services to offer now. We have physical therapy, optometry, offices, clinical staff, X-ray labs and everything else we need for our students," Kristie Hendrix, Patient Assistant Nurse said.

The physical therapy room has two private and semi-private rooms. It has a treadmill, leg press, bike, rebounder, stepper and upper body ergometer. This equipment is used to test out the flexibility of the patients.

"Without students, there wouldn't be a Health Services on this campus," Hendrix said.

For further information, email Health Services at health@georgiasouthern.edu or call them at (912) 478-5641. Health Services is open Monday through Friday.

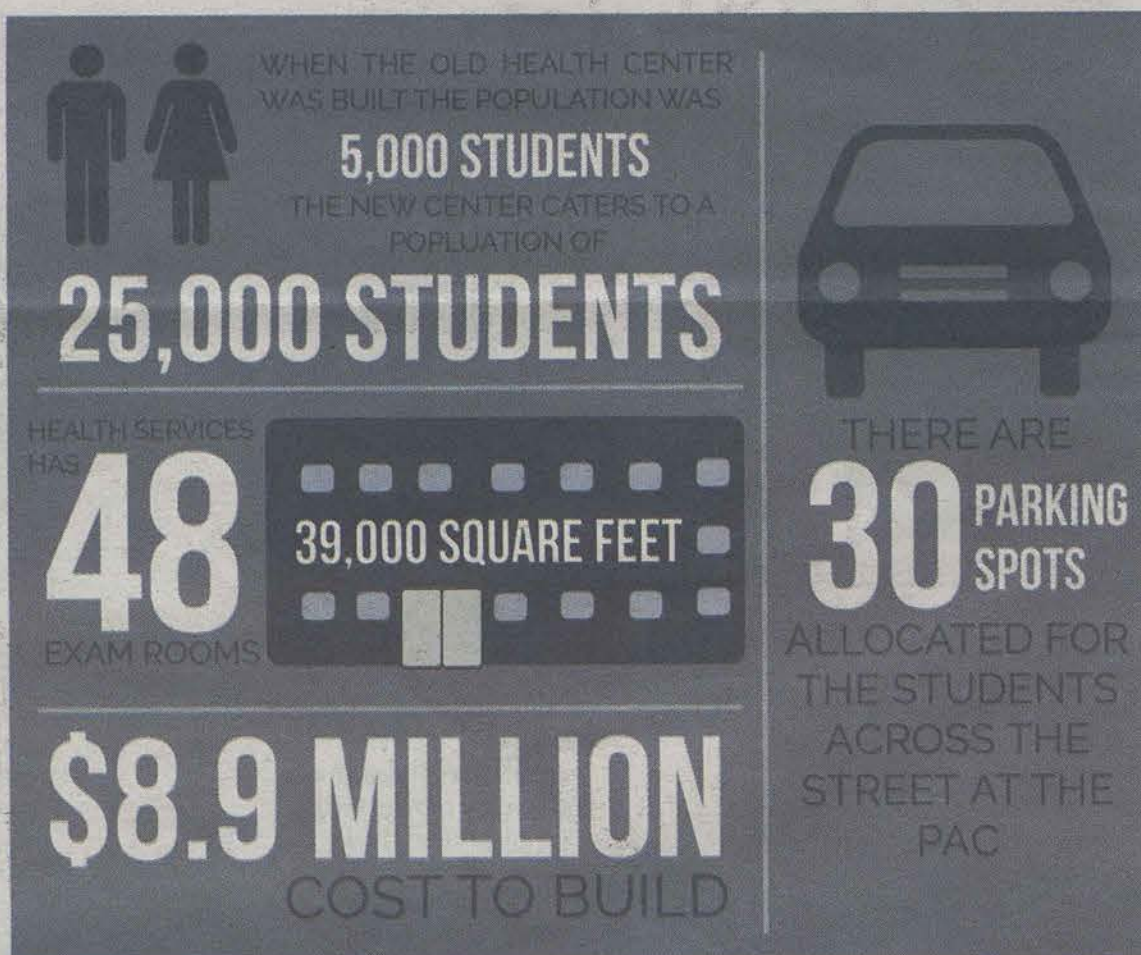

TAHIR DAUDIER THE GEORGE-ANNE
Mary Kicklighter demonstrates one of the instruments at the new facility. The Health Services building was opened to students Jan. 11.

COME IN TO THE
**GEORGE-ANNE
NEWSROOM**

IN THE
**WILLIAMS
CENTER**

TO APPLY FOR
**STUDENT
MEDIA!**



**JANUARY
14TH, 15TH
18TH & 19TH**

10 A.M. - 2 P.M.

SPRING 2016 JOBFAIR

PROPEL YOUR FUTURE



TO NEW HEIGHTS.



Thursday, January 14 • 9 a.m. – Noon
Russell Union Ballroom

Business casual dress required • Meet potential employers • On-site interviews

DEPARTMENT OF HUMAN RESOURCES
STUDENT EMPLOYMENT CENTER
GEORGIA SOUTHERN UNIVERSITY

f GASouthernSEC

@GASouthernSEC

gasouthern_sec

Congratulations to the 2016 SOAR Team!

Brandon Ashiedu
Sophomore
Mechanical Engineering
Douglasville, GA

Chandler Avery
Sophomore
Mechanical Engineering
Hoschton, GA

Josh Bailey
Sophomore
Chemistry
Waycross, GA

Courtney Dyer
Senior
Psychology
Dahlonega, GA

Doug Flott
Junior
Pre-Business
Brooklet, GA

Savannah Freeman
Sophomore
Pre-Business
Woodstock, GA

Nick Hartney
Junior
Pre-Information Technology
Marietta, GA

Alec Joiner
Junior
Marketing/Retail Management
Cordele, GA

Sydney Jordan
Junior
Pre-Business
Gray, GA

Marcus Joyner
Junior
Information Technology
Evans, GA

Megan King
Junior
Early Childhood Education
Roswell, GA

Abbey LaMee
Junior
Child & Family Development
Therapeutic Recreation
Jasper, GA

Charabete Louis-Jacques
Sophomore
Biology
McDonough, GA

Moses Malloy
Freshman
Mathematics
Richmond Hill, GA

Daniel Marin
Sophomore
International Trade
Woodstock, GA

Courtney Rorex
Junior
Journalism
Austell, GA

Alexa Rushworth
Sophomore
Public Relations
Atlanta, GA

Crystele Seya
Junior
Pre-Business
Lithonia, GA

Kat Shuman
Sophomore
English
Reidsville, GA

Danielle Souza
Sophomore
Biology
Londonderry, NH

Emily Stephens
Sophomore
Pre-Business
Atlanta, GA

Devin Thornton
Freshman
Pre-Business
Lithonia, GA

Tyler Wilson
Senior
Management
Adrian, GA

Matthew Windham
Junior
Chemistry
Cordele, GA

Kiera Zellerer
Junior
Marketing
Savannah, GA