

Georgia Southern University

Digital Commons@Georgia Southern

The George-Anne

Student Media

10-15-2013

The George-Anne

Georgia Southern University

Follow this and additional works at: <https://digitalcommons.georgiasouthern.edu/george-anne>

Recommended Citation

Georgia Southern University, "The George-Anne" (2013). *The George-Anne*. 2809.
<https://digitalcommons.georgiasouthern.edu/george-anne/2809>

This newspaper is brought to you for free and open access by the Student Media at Digital Commons@Georgia Southern. It has been accepted for inclusion in The George-Anne by an authorized administrator of Digital Commons@Georgia Southern. For more information, please contact digitalcommons@georgiasouthern.edu.



**'CAPTAIN PHILLIPS'
STAYS
AFLOAT**
PAGE 12



**HITS TO
MAKE
IMPACT**
PAGE 6

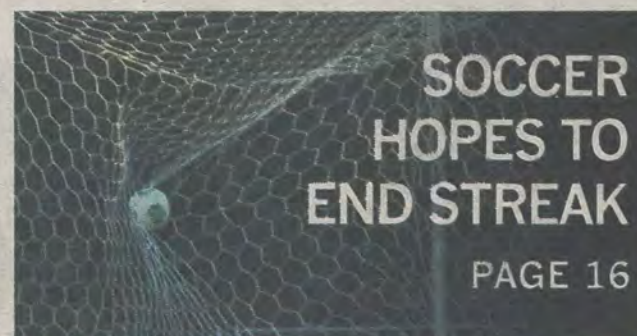

**SOCCER
HOPES TO
END STREAK**
PAGE 16

Tuesday, October 15, 2013
Georgia Southern University
www.thegeorgeanne.com
Volume 84 • Issue 29

THE GEORGE-ANNE

ITS prioritizes educational sites

BY CAITLYN OLIVER
The George-Anne contributor

Georgia Southern University's Information Technology Services (ITS) will be more directly controlling network traffic until bandwidth improvements are fully available next semester.

Academic programs and websites like FOLIO and Galileo are given priority while social media sites have a much poorer

performance, Steven Burrell, vice president for information technology services and chief information officer at GSU, said.

"We want to make sure students and faculty have access to everything they need for their work," Burrell said.

ITS has recently stepped up its control of on-campus bandwidth priority. Priority status depends on the service. It will not be possible to differentiate educational from non-educational content within the service.

For example, YouTube videos are used in certain classes. If YouTube is given priority, it won't be possible to differentiate useful videos from silly stuff online, Burrell said.

Students streaming Pandora and cruising Facebook on university computers uses up the limited bandwidth and slows down all other services.

See **BANDWIDTH**, Page 7

GSU gets sweet revenge against The Citadel

BY RANDALL HAMPTON
The George-Anne staff

The final chapter of the heated rivalry between The Citadel and the Georgia Southern University football team came to a close when GSU held on for a 28-21 victory.

Last year, the Bulldogs handed the Eagles their first loss of the season in a 23-21 slugfest, but things were different this year with the added dimension of GSU redshirt freshman quarterback Kevin Ellison.

The Eagles managed to keep their composure after falling behind in the fourth quarter. Ellison fumbled a pitch and the Bulldogs' junior safety Akeem Garnett scooped and scored from 36 yards out to give the Bulldogs a 21-20 lead. The Eagles were in danger of falling to 3-3 with a 1-3 conference record.

"We had to be calm and collected and make sure we really came together as a team," Ellison said. "[We had to] make sure we were all on the same page so we could go out there and execute to be able to put points on the board."

Ellison racked up 273 of the Eagles 498 total yards and completed 70 percent of his passes for 138 yards. It was Ellison that helped keep the game-winning 86-yard drive alive by juking his way past defenders for 14 yards on third and seven in GSU territory.

See **REVENGE**, Page 18

FARM truck pays to educate



Christal Riley | The George-Anne

The Farm Animal Rights Movement (FARM) pays students \$1 to watch a four-minute video on animal cruelty. The FARM truck will be parked outside Einstein's until 4 p.m. today.



thegeorge
anne.com



Follow us on Twitter
@TheGeorgeAnne



Newsroom 478-5246
Advertising 478-5418
Fax 478-7113

PO Box 8001
Statesboro, GA
30460

SGA plans for fall semester events

BY TANNIS KUFNER

The George-Anne contributor

The Student Government Association (SGA) president, Garrett Green, and his senate are involved in the organization of events across campus throughout the fall semester.

#ThrowbackThursday Dance

SGA and the National Pan-Hellenic Council (NPHC) are joining together to host a formal dance open for all GSU students. The dance is set to have a theme of #ThrowbackThursday on Dec. 5 with the location still to be announced. All of the proceeds from the formal will go to the Eagles for Eagles fund.

"NPHC fraternities and sororities do not have formal dances and this partnership gives them a chance to come together to host a dance," Green said.

Quality Enhancement Plan (QEP)

The GSU administration chooses a new topic every five years that focuses on an area to improve the academic curriculum. The last time the QEP occurred, the FYE programs were developed.

There will be another initiative in the QEP that is leaning towards effective writing and increasing writing skills, Green said.

Fund Fair

SGA's Financial Advisory Committee (FAC) is in charge of allocating funds from student fees and approving whether organizations that apply for funding will receive their requested funds, and these organizations will be presenting Nov. 18 at the Fund Fair.

All of the organizations that have received funding from SGA's FAC will be in attendance and presenting how they have used the funds, Green said.



GARRETT GREEN

Green said that some student organizations have attended conferences and hosted events because of this money and the Fund Fair is a chance to display how student fees are spent.

Student Advisory Council

Every SGA president in the University System of Georgia will be meeting on campus. This will be the first time GSU is hosting this event in five years.

They will be discussing business regarding legislation that can affect campuses across Georgia, Green said.

The event will be held Nov. 15 – Nov. 16.

Doo-dah Dance and Step Show

SGA and University Programming Board (UPB) are collaborating during homecoming week this year for the Doo-dah Dance and Step Show, Nov. 6 at 7 p.m.

The \$1 admission fee will go to Eagles for Eagles, Green said.

Eagle Alert Forum

In the Russell Union Ballroom on Oct. 30, representatives from various offices such as on-campus safety, on-campus housing, off-campus housing and the Dean of Students will be hosting a forum focused on student safety, Green said.

GSU Idol

GSU Idol is sponsored by SGA and will be Monday, Nov. 4, at 7 p.m. in the Russell Union Ballroom.

This yearly event will be held in the Russell Union ballroom and is expected to have great attendance by the student body, Green said.



File photo

The Doo-Dah step and dance competition features performances from student organizations across campus. Student Government Association will be helping to host this year's competition.

Police Beat

Friday, Oct. 11

9:00 a.m.: An incident report was taken for an entering auto that occurred on an earlier date. This case was assigned to criminal investigations.

10:48 a.m.: An incident report was taken for a theft of a bike at the Kennedy Hall bike rack. This theft occurred in late September – early October 2013. This case was assigned to criminal investigations.

1:31 p.m.: Officers responded to a panic alarm/sick person at Watson Pods. EMS responded and transported the sick person.

2:19 p.m.: A motor vehicle accident report was taken for a motor vehicle accident in Lot 21.

2:26 p.m.: A motor vehicle accident report was taken for a motor vehicle accident in Lot 42.

2:30 p.m.: A motor vehicle accident report was taken for a motor vehicle accident on Olympic Blvd.

3:30 p.m.: An incident report was taken for a suspicious incident that occurred in J-Lot. The complainant reported a reckless vehicle in the parking lot almost struck her.

3:55 p.m.: An incident report was taken for theft of unattended property at Eagle Village. The victim advised that he placed his clothes in a washing machine on Tuesday and came back to get the clothes on Friday but the clothes were missing. This case was assigned to criminal investigations.

9:23 p.m.: An incident report was taken for theft of unattended

property at the RAC. This case was assigned to criminal investigations.

Saturday, Oct. 12

8:25 a.m.: Officers responded to a burglar alarm at the College of Education. The alarm was accidentally activated by an employee.

1:30 a.m.: Officers conducted a traffic stop on Georgia Ave. The driver of the vehicle, Walter Frank Hughes, Jr., 24, Ashburn, Ga., was arrested and charged with Too Fast for Conditions & DUI 1st.

7:30 a.m.: Officers responded to a burglar alarm at the College of Business. The alarm was accidentally activated by maintenance personnel.

2:00 p.m.: Officers discovered an intoxicated person at Paulson Stadium. The intoxicated person was judicially referred for an alcohol violation.

2:29 p.m.: Officers made contact with suspicious persons in the Paulson parking lot. Information was obtained from the suspicious persons.

2:30 p.m.: Officers responded to a sick person at Paulson Stadium. EMS responded but did not transport.

3:24 p.m.: Officers responded to an injured person at the Paulson Stadium Bus Stop. EMS responded but did not transport.

3:25 p.m.: Officers responded to Kennedy Hall in reference to a criminal trespass and a fire alarm. Maintenance and the Statesboro Fire Department responded. This case was assigned to criminal investigations.

7:27 p.m.: Officers responded to a civil matter at Watson Pods. Housing personnel responded and assisted in mediating the problems.

10:00 p.m.: Officers made contact with two suspicious subjects at The Cove at Southern. Information was obtained from the subjects.

10:03 p.m.: Officers made contact with a suspicious person on Chandler Road at Property Mart. Information was obtained from the suspicious person and a subject she had made contact with. A residence hall key was taken and placed in the Public Safety Property Room.

Sunday, Oct. 13

1:25 a.m.: Officers assisted the Statesboro Police Department with an incident (fight) in front of The Rusty Tavern in University Plaza.

2:25 a.m.: Officers responded to a panic alarm at Southern Courtyard. The occupants believed that an unknown intoxicated subject had activated the alarm.

2:44 a.m.: Officers responded to Freedom's Landing in reference to an injured person. This case was assigned to criminal investigations.

3:32 a.m.: Officers responded to a fire alarm and criminal trespass at Kennedy Hall. Unknown persons activated a fire extinguisher. The Statesboro Fire Department and maintenance responded. This case was assigned to criminal investigations.

1:52 p.m.: A motor vehicle accident report was taken for a motor vehicle accident at Southern Courtyard.

Statement of Operations

The George-Anne is the official student newspaper of Georgia Southern University, owned and operated by GSU students using facilities provided by the university. The newspaper is the oldest continuously published newspaper in Bulloch County. The newspaper is a designated public forum for the Georgia Southern community. The newspaper is published twice weekly, on Tuesdays and Thursdays, during most of the academic year. Any questions regarding content should be directed to the student editor by phone at 912.478.5246 or at gaeditor@georgiasouthern.edu.

ADVERTISING: The newspaper accepts advertising. Inquiries may be made by calling 912.478.5418 or 912.478-0566. Fax any questions to 912.478.7113 or e-mail ads1@georgiasouthern.edu.

The George-Anne receives additional support, in part, from the Student Activities Budget Committee.

The deadline for reserving space and submitting advertising copy is noon, one week prior to the intended publication date. For more information, rate cards, sample publications, contact

the advertising manager or student media director. The advertiser is responsible for any errors in advertisements and its liability for adjustments is limited to the amount of space the error occupied in the ad. Further, the newspaper is not responsible for any damages caused due to an ad's omission from a particular edition and its responsibility solely is to reschedule the ad in the next regular edition at the regular advertising rates.

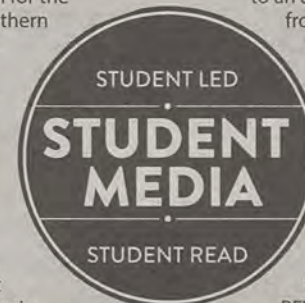

STUDENTS BEWARE: The George-Anne screens all advertisements prior to publication. The newspaper strives to accept ads for legitimate products and services only. Students are urged to exercise caution when replying to ads-particularly those that require personal information. Students are also urged to report to the newspaper any suspicious offers which they might see in an ad.

PUBLICATION INFORMATION: The newspaper is printed by The Brunswick News in Brunswick, Ga.

NOTICE: Unauthorized removal of multiple copies from a distribution site constitutes theft under Georgia law, a misdemeanor offense punishable by a fine and/or jail time.

Editorial Staff

Editor-in-Chief Shelby Farmer
Managing Editor Jackie Gutknecht
Multimedia Editor Lindsay Gaskins
Opinions Editor James Farmer
News Editor Will Price
News Chief Lauren Gorla
A&E Editor Kimeko McCoy
A&E Chief Lilly McCann
Sports Editor Shakeem Holloway
Sports Chief Robert Huitt
Football Editor Randall Hampton

Copy Chief Anna Wells
Copy Editor Taylor Cooper
Business Manager Chloe Douglas
Sr. Account Executive Jeremy Williams
Marketing Manager Marissa Martin
Distribution Manager Bradley York
Production Manager Jose Gil
Photo Editor Jessica Stanfield
Design Editor Matt Veal
Web Editor Darius Alexander
Ads Design Chief Kelly Slyfield

Corrections

Contact the editor at gaeditor@georgiasouthern.edu for corrections and errors.

Our View

Lotto should rethink prizes

The Georgia Lottery Corporation is doing students in participating universities a service by offering \$1,000 scholarships and one full-ride scholarship to students attending certain home games. However, the Lottery's decision to give away eight Segways is a questionable decision at best.

College students will have very little use for Segways as opposed to a laptop or tablet prize. In fact, at Georgia Southern University, the Segways would not even be allowed on the Pedestrium. At best the winner could sell the Segway to get money, and at worst it would just take up room in the winner's apartment.

If the Segways were purchased by the Lottery, it is a terrible misuse of funds on an item with little to no demand on campuses. But even if the Segways were gifted, at a retail value of \$9,130.44, the Segways could be sold by the Lottery and used to fund an additional full-ride scholarship or 72 other \$1,000 dollar scholarships or even added to the \$1,000 scholarships to make them worth \$10,000. Any amount of additional money added on to a scholarship would be greatly appreciated by the winning students.

There is no problem with giving away additional scholarship money, but the Georgia Lottery should give away prizes that are actually useful to college students. Segways are not useful for the majority of college students, and are, in fact, useless to some students with disabilities.

The George-Anne welcomes letters to the editor and appropriate guest columns. All copy submitted should be 350 words or fewer, typed, and sent via e-mail in Microsoft Word format to letters@georgiasouthern.edu. All submissions must be signed and include phone number for verification. GSU students should include their academic major, year and hometown. The editors reserve the right to reject any submission and edit submissions for length.

Opinions expressed herein are those of the Board of Opinions or columnists themselves and DO NOT necessarily reflect those of the faculty, staff or administration of GSU, the Student Media Advisory Board, Student Media or the University System of Georgia.



Rouhani can be a catalyst of change

Lost amidst the rhetoric of Syria, debt ceilings, government shutdowns and U.S.-Russian relations have been the work of the new Iranian president Hassan Rouhani. Rouhani has quietly impressed the political and journalistic spheres with his leadership style. He is not as bellicose or aggressive as his predecessor, Mahmoud Ahmadinejad, which automatically made him seem better by default. Rouhani and President Obama were the first two leaders of their respective countries to actually speak to each other since the Iranian Hostage Crisis in September.

However, serious issues still remain between Iran and the United States. First off is Iran's desire for a nuclear program, which the state claims is for nuclear power, but many Western states believe is for nuclear armament. The U.S. and its allies have given Iran harsh treatment due to these desires and have even

THE FARM LIFE



JAMES FARMER

violated Iranian sovereignty to prevent the program from progressing. Cyber-espionage and sabotage are frequent threats to the Iranian program, not just from the U.S. but from Israel as well.

Israel and Iran have been at a constant state of bad relations ever since the Israeli state was founded. To this day, it is still the official position of Iran to not acknowledge the Holocaust (though Rouhani has made some concessions) and the state of Israel. The near-unwavering support of Israel and its policies by the United States has

been a thorn in the side of Iranian-U.S. relations for years, but that does not look to change anytime soon. Israel provides the U.S. influence in the region that is much needed.

Iran has been wary of the U.S. for a long time, from the CIA coup in the 60s that removed the democratically elected president and installed a religious dictatorship to the seemingly constant U.S. military presence in the region in current times.

It will take charismatic and capable leaders on both sides to repair the mess that is the relationship between the two countries. Rouhani is making steps for Iran, but who will step forward for the U.S.? Whoever it is needs to step forward soon, before this opportunity vanishes.

Farmer is a senior political science and international studies major from Thomasville. He is the current Opinions Editor.

Democrats must negotiate

On Thursday, the government will no longer have the ability to pay its debts. We would potentially default on our loans and it would have drastic consequences for our economy. It also would be the only time in U.S. history that we have defaulted. But don't forget that the government is also partially shut down. More than 350,000 federal workers have been furloughed, while some states and private companies have been allowed to pay the cost to run some national parks and services.

As I have said, the debt ceiling is almost ceremonial since we can raise it at any time. Unfortunately, it still must be raised in order for us to pay our debts. This limit technically doesn't raise the debt; it just allows us to pay for what we have already spent. Every time the Treasury asks for it to be raised, ideological issues are piggybacked onto the bill. That is why you have been hearing about "clean" bills, because people want them to focus solely on the debt limit.

It has become obvious that Congress is at a standstill. This is what happens when you have divided government during a time of great economic importance. We are entering the third week of the shutdown, and there is no solution in sight. Senators Reid and McConnell cannot even meet in person, they have to call each other, and yet no decision has been made. The impasse at the moment

MY ELEPHANT OPINION



AMBER PORTER

stems from how long we want the limit to be increased, whether for a few months or a year, as well as whether to keep sequestration cuts in the budget or not.

No matter what Republicans are proposing, however, Senate Democrats refuse to negotiate. Senate Majority Leader Harry Reid is more than likely not going to budge much on anything because he feels he doesn't need to. He must realize that Americans voted in a Republican majority in the House for a reason, and he needs to listen to them. If they cannot agree on anything by the deadline, I am honestly unsure of how America will react. I thought it couldn't get much worse than a three-week shutdown, but defaulting would incur a global economic crisis. Here's to hoping Congress can raise the roof so we don't look like a joke to the entire world.

Porter is a junior international studies major from Zebulon. She spent spring semester as a Capitol Hill intern.

Just raise the debt ceiling

Who's ready for a debt ceiling faceoff? Congress is gearing up for yet another avoidable showdown on Capitol Hill caused by the debt ceiling. We have seen this unnecessary battle take place before in Washington, but this one might prove to be the biggest waste of time yet.

Understanding the concept of the debt ceiling and why it should be raised is simple: America has to pay its bills. Raising the debt ceiling allows for the treasury to pay off debts the U.S. government owes. The debt ceiling isn't raised to spend new money, it's raised to pay for the programs and expenditures Congress had already decided to spend money on. If the debt ceiling is not raised, Congress is simply telling those who we owe money to that we will not be paying them back.

Previous presidents like Ronald Reagan, who raised the debt ceiling over 15 times, and George W. Bush all have raised the debt ceiling without receiving any kind of backlash from Congress. However, due to the volatile atmosphere radical Republicans and Tea Partiers have created in Washington, House Republicans are hell-bent on destroying the Obama presidency and eventually America with these idiotic tactics in hopes of proving an ideological point that does not apply in the debt ceiling debate.

When a group of House Republicans declares it won't budge on the debt ceiling issue, it is putting the markets and the full faith and credit of the United States in

THE LIBERAL DOSE



CHRIS WARE

jeopardy. But the House Republicans see no problem in making America's leaders look like deadbeat politicians just to try to make the president look bad, even though they would be diminishing the reputation of the United States as a whole if we send the message that the nation's bills won't be paid.

We are all tired of hearing about these manufactured political catastrophes that are 100 percent avoidable. Our country is being crippled by politicians who have plans to accomplish individual or party agendas while the American people end up with the bad end of the deal. The Tea Party could care less about this country and the reputation we hold for being an exceptional nation. The members of the Tea Party in Washington are the true political terrorists, and we need to rid ourselves of this Tea Party sickness that has plagued the political process of this nation for far too long.

Ware is a sophomore political science major from Griffin. He is involved with the Young Democrats and has worked on various political campaigns.

Default would be a disaster for everyone

Last week I took the liberty of pegging the Tea Party as the faction responsible for the government shutdown still raging on. Continued efforts to circumvent the Affordable Care Act's implementation through such reprehensible tactics remain to be both childish and reckless, especially as it harms average Americans simply trying to make a living.

An equally pressing issue that is being lost in the mist of the headline-grabbing government shutdown is the looming deadline of raising the debt ceiling. The debt ceiling, or the legal amount of debt our government can accrue, must be raised by our woefully-incompetent Congress before Thursday or our country will default on the payments we owe and litanies of disastrous consequences begin to emerge.

During the 2011 debt-ceiling debates the

THE BOOK OF ELI



ELIJAH ANDERSON

Dow-Jones Industrial Average fell a shocking 2,000 points, and the U.S. credit rating was downgraded for the first time in history. In other words, it absolutely sucked for our economy and reputation. Consumer confidence was shaken and the lethargic recovery was rattled by the dramatic late-night dealings of Congress, and this was even though a compromise was made and the debt ceiling was raised!

Failing to raise the debt ceiling this time will prove just as damaging to our economy if not worse than in 2011. It will signal that we, the most powerful country in the world, are incapable of paying our bills in a timely manner. A display like this will translate negatively into the financial markets where businesses and other investors will be uncertain of how to react. Some economists are even projecting that a failure to raise the debt ceiling could launch us into another recession, far worse than the one we are finally emerging from. Businesses will be unlikely to hire, proving damaging for students coming out of university with thousands of dollars of student loans to pay off. This, among other things, evidences why the debt ceiling must be raised, but I do not unconditionally agree.

With all this being said the United States has a serious spending problem. Our debt stands at nearly \$17 trillion. Democrats are sure to point out that the debt ceiling, since its inception during WWI has never been used as a bargaining chip before, but I would like to point out that the debt that we owe has never been so astronomically high. Desperate times often call for desperate measures and President Obama is wrong for refusing to negotiate with Republicans on spending cuts. Our spending habits stand to ruin our financial future and the Republican Party seems to be the only entity conscious of this issue. It's time for Democrats to wake up and realize this problem too.

Anderson is a senior political science major from Cumming. He is writing a thesis on U.S. interventions.

Heads up

Research team uses football to study brain trauma

BY ALANNA NAVIN

The George-Anne staff

The Georgia Southern University Health and Kinesiology Department are conducting research on traumatic brain injury and its effects on student athletes.

This research is focusing on two topics. The first is how concussions occur, the other is understanding their implication and what happens to a person after a concussion, Tom Buckley, professor of health and kinesiology at GSU, said.

To understand how concussions happen, a special system is used to measure the force of an impact on a football helmet.

The Helmet Impact Telemetry System (HITS) consists of six sensors that are placed inside the helmet, which is flushed against a person's head.

When a helmet gets hit, each sensor registers the acceleration of the impact and runs all of the measurements together to give an output of the

linear and rotational accelerations to the head.

"In essence we know how hard you got hit, where you got hit and how long you got hit," Buckley said.

Eric Schiflett, graduate student of athletic training, operates HITS.

"I take the HIT System out to football practice everyday, I monitor it occasionally during practice and I also have a pager that will notify me when somebody takes an above-threshold hit," Schiflett said.

"So we go look back to see where it was, how hard it was and the rotational forces," Schiflett said.

The threshold of where traumatic brain injuries most often occur is at and above 98 g (one g is the acceleration due to gravity at the Earth's surface).

From the data, Buckley and his team know there are certain types of impacts people are more likely to get concussions from.

The team can look at the data and if certain types of impacts occur, a correlation

of the impact to what kind of exercise or drill can be made.

Specific types of drills at practice put a person at a higher risk. Buckley and his team can help modify the type of drill they are doing so as to put the players at less of a risk than before.

However, the HITS System is not predictive.

"You can't prevent it. I mean, it's a violent sport, concussions are going to happen, but maybe you can minimize it," Buckley said.

After a student athlete receives a concussion, another project that is funded by the National Institute of Health (NIH) looks at the track of recovery.

The project primarily focuses on gait and posture control after a traumatic brain injury.

After a person receives a concussion, their balance is affected and becomes worse. It has also been found that it takes a long time for a person to recover, and everyone recovers differently, Buckley said.

There is a long mat that runs along the center of a gymnasium where the research

takes place. The long mat contains force plates, which are essentially really expensive bathroom scales, Buckley said.

The force plates measures and calculates the center of pressure on the ground while a person is walking using a technique based on Newton's laws of motion: every action has an equal and opposite reaction.

"When they come in as freshman some of them have had concussions, some of them haven't, so we test all of them. If they do get a concussion, then we can look at recovery," Kelsey Evans, graduate student of exercise science, said. Evans runs the recovery research in the project.

Some people can recover in a few days while others can take up to several months to full recover, Buckley said.

"There is no one set recovery and that makes concussions different from most other injuries," Buckley said.

Buckley said, "It's a very unique individualistic approach. No two are the same."

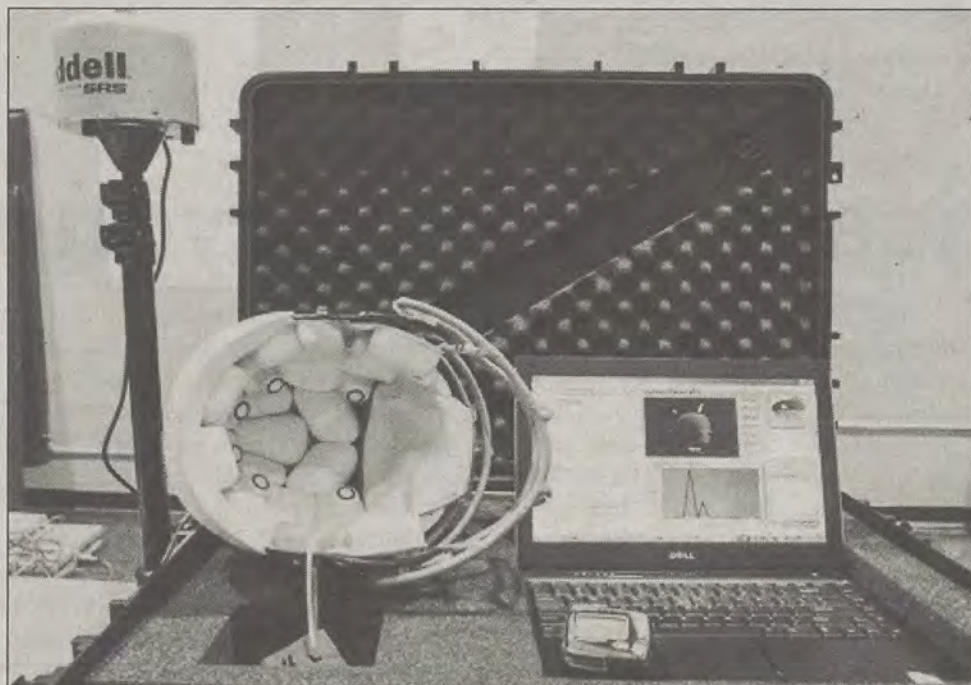

Courtesy of The Health and Kinesiology Department

The HIT system uses a helmet and wireless technology to measure the head trauma incurred when football players receive an impact. Researchers collect data from the GSU football team's practice. A team of GSU professors and students have been working together to understand the effects of brain trauma and how different individuals recover.



Facts about concussions

(taken from the National Collegiate Athletic Association- NCAA)

- Data from the NCAA Injury Surveillance System suggests that concussions represent 5 to 18 percent of all reported injuries
- Concussions can occur in any sport
- Athletes can still get a concussion even if they are wearing a helmet
- Concussions can occur from blows to the body as well as to the head

BANDWIDTH, from page 1

"We found it necessary to shape traffic because peer-to-peer applications used a lot of bandwidth," Burrell said.

"When the library was built they put in wireless nodes but underestimated how many wireless devices would be using them and that's part of the problem," Tony Ard, information services librarian, said.

Peak utilization hours are from 10 a.m. to 4 p.m., aligning with normal business hours. It is recommended to use non-essential services before or after these times, rather than during, to improve connection speed.

A second fiber-optic link to improve Internet speed was added to campus the first week in October and will be ready for use by

the start of spring semester.

"The construction of a second fiber-optic link to Peachnet (state-wide internet services for the University System of Georgia) provides two benefits: the ability to utilize more bandwidth and a 'backup' link, in the event that one of the fiber-optic cables is cut accidentally, or if there are electronic

failures," Burrell said.

"Part of the problem is so many devices that use wireless action these days. It overloads the nodes a little. Most of the issues I've seen have been with wireless devices," Ard said.

To conserve bandwidth, ITS suggests that students turn off Wi-Fi on personal devices that connect to the network but do not get used.

Peak Internet use hours: 10 a.m. to 4 p.m.

During this time, ITS recommends students and faculty on campus to stray away from using non-academic websites such as Facebook and Pandora. This is when the effects of the bandwidth capping will be felt the most.

Low Priority

- YouTube ● Pinterest
- FaceBook ● Pandora
- Twitter

High Priority

- WINGS
- Galileo
- Folio
- Google

Brandon Coe | The George-Anne



The Sir Shop
Statesboro Mall
912.764.6924

BERETTA
PEACH STATE PRIDE

Lifting the veil off the true costs of college

BY ADRIENNE LU

Stateline.org

A new online app called College Abacus is making it easier for students and their families to get estimates in advance of how much financial aid colleges and universities will give so that they can compare schools for costs.

It comes at an opportune time, since the shutdown of many government programs because of the political standoff over the federal budget has disabled College Navigator, a tool also designed to help families figure out college costs and operated by the Department of Education.

Until about two years ago, financial aid was a mystery until a student got a college acceptance letter and a financial aid package.

Change began in 2011, when the federal government required schools to offer online net price calculators, which compute a school's full cost of attendance, minus estimated scholarships, based on

“ Even if the government has stopped working, parents still need to find financial aid for their students to go to college ”

-Abigail Seldin,

College Abacus, co-founder

family income and other information that individuals enter.

College Abacus is a free, one-stop shop. It taps the net price calculators at three schools a student selects. Then, based on personal information entered once into College Abacus, the site retrieves the estimates. More schools can be entered, three at a time.

The federal government's College Navigator website offers a rougher estimate. For each school, it will give estimated net prices for several income levels.

And finding out in advance which schools are likely to be affordable can bring peace to households in the spring,

when most full-time students get their college decisions, Seldin said.

It also can help reduce student debt. Referring to a popular travel accommodations search engine, Seldin calls College Abacus the kayak.com of net price calculators.

It takes 10 minutes or more to copy financial information from a tax return and answer other questions on many net price calculators.

College Abacus lets a user log in via Facebook, Google-plus or Twitter and save the data so that it only has to be done once.

The free service isn't without some glitches. It requires the patience to wait a

few minutes for some estimates.

In some cases, as when schools take their calculators down for revisions, College Abacus can't get results.

Seldin said her staff of 10 checks the school websites to make sure they're working and that it should take no more than one week before the estimate will be produced on another try.

Another issue with the estimates is the quality of the net price calculators.

Many schools use a simple calculator developed by the Department of Education, rather than ones developed by the College Board and others that ask more detailed financial questions.

One important question the Department of Education calculators don't ask is the amount of parents' assets.

The Free Application for Federal Student Aid (FAFSA), a form required of all students who hope to get financial aid, asks about assets and schools use FAFSA information when they decide on aid amounts.

Study shows two-year diplomas worth more

BY RENEE SCHOOF

McClatchy Washington Bureau

Students who earn associate's degrees and occupational certificates often earn more in their first year out of college than those with four-year college degrees, according to a new study examining the average salaries of graduates in five states.

For the study, College Measures, a partnership between the American Institutes for Research and Matrix Knowledge Group, worked with Arkansas, Colorado, Tennessee, Texas and Virginia to obtain data on how much graduates from two- and four-year colleges in those states earned in their first year after graduation.

"The findings challenge some conventional wisdom, showing for example that what you study matters more than where you study," Mark

Schneider, president of College Measures, said. "The right choices can lead to good careers and good wages while the wrong ones can leave graduates with mountains of debt and poor prospects for ever paying off student loans."

Schneider said states tend to put a lot of money into the flagship universities, the best-known research institutions in each state.

But his study indicates state legislators should focus more attention and funding on community colleges, which "can represent a good way for residents of a state to get the training that they need to get into the local labor market and earn a reasonable wage."

Schneider said that regional four-year public colleges should also take a cue from community colleges and think more about how they can best

train students to fill the needs of local job markets.

Among the lessons of the study: Short-term credentials, such as two-year degrees and technical certificates, can be worth more than bachelor's degrees in early years.

The study found that in Texas, those who graduated with technical associate's degrees earned over \$11,000 more on average in their first year after graduation than those with four-year degrees.

Those who graduate from flagship campuses who entered the job market directly after graduation did not earn more than graduates of regional college campuses. In all five states, those who graduated with engineering degrees earned the most.

Graduates with degrees in technology, engineering and math earned more than other majors, but

the study found no evidence that those with science degrees in subjects such as biology or chemistry earned higher wages.

Each of the states in the study matched student records with data collected from the state's unemployment insurance database. Every state used data from its public universities.

Arkansas, Colorado and Virginia also reported data from some private, not-for-profit institutions.

The study did not include earnings of students who moved out of state after graduation.

About 20 states nationwide have the kind of data used in the study, Schneider said, but most do not make the information easily accessible to the public.

"What we've done with these five states, every state should be doing," Schneider said.



There is more game coverage online at thegeorgeanne.com. If you're looking for the latest sports coverage online our website has what you need. You can also find us on Twitter and Facebook for minute-by-minute updates. Wherever you are, we're there with you. Enjoy the game.



@thegeorgianne



The George-Anne



Sports Talk with The George-Anne

Falling for you: A guide to fall dating in the 'Boro

Seasonal

BY LILLY MCCANN

The George-Anne staff

Fall is short-lived in the South, especially in Statesboro. There are typically two seasons, summer and winter, and with fall settling in Statesboro so follows the festivities that are perfect for date nights.

Pumpkin Patch

Pumpkins are inseparable from the fall season. Students looking for a Monday date night idea that combines creativity, cool weather and embracing your inner child, visiting a pumpkin patch may sate those desires. The satisfaction of carving a pumpkin is something that is hard to outgrow. Students can enjoy the fruits of their labor by snacking on roasted pumpkin seeds from a freshly carved masterpiece.

Discover the Best Local Pumpkin Flavors

It is no mystery that, for some reason, everything with cinnamon and pumpkin flavors tastes better in the fall. Lattes, pastries, beers, pancakes, the options are endless but the trick is finding the perfect one.

For coffee lovers, Starbucks and Elliano's offer a variety of coffee concoctions.

"We have a pumpkin white mocha and a pumpkin chai latte. That just took off, but a lot of people like the mocha," Austin Tadlock, Elliano's barista said.

For students that haven't ventured far from the standard Starbucks drink menu, the Pumpkin Spice latte is an incredibly popular choice, Starbuck's barista Joe Farris said.

"We literally have people ask us year round, 'When is the pumpkin spice coming back?' They literally wait all year for these drinks. I love the Pumpkin Spice Latte. It is like a warm pumpkin pie in a cup, perfect for those chilly fall days," Farris said.

Students looking to satisfy that sweet tooth, Sugar Magnolia Bakery offers pumpkin chocolate mini loaves or Simply Sweet Cakery for pumpkin spiced cookies.

For students looking for something unconventional and with a little kick, Southern Growlers may have just the thing.

"We switch out the kegs constantly, but we normally have seasonal brews on draft. We keep a cider on tap and right now we have New Belgium Pumpkick," Jamie Carr, Southern Growlers employee, said.

Old Freeman Family Farm

The Old Freeman Family Farm, located between Statesboro and Sylvania is a 150-acre farm that offers fun fall festivities all night. Whether you're looking for a group-date night or just a twist on your regular date night, the Family Farm makes it possible.

Students can start by navigating through the 5-acre corn maze, and see which couple, or partner, can make it through first. After, students can snuggle up on a hay wagon that travels through the sights and sounds of the farm, and for the braver ones the farm also offers a Haunted Hay ride.

Kiwanis-Ogeechee Fair

Just like pumpkins, fairs could be considered synonymous with the fall season. Students wishing to have a night filled with playing games, riding rides or eating deep-fried Oreos, the annual five-day fair, beginning Oct. 21, could be the perfect way to spend the evening. Couples could take a ride on the Ferris wheel and have that

cliché kiss at the top, or play games at the booths until you win that oversized stuffed animal that only seems in-place at the fair.

Wine and Dine

A well-kept secret tucked in the Statesboro countryside; Meinhardt Vineyards and Winery promises to keep the romance running all night long for students looking to wine and dine. Twinkling lights wrapped around rafters match the nighttime stars in their outdoor seating area nestled in the heart of the country. The winery offers free tasting and tours, and is open from 11 a.m.-9 p.m. on Saturdays and Sundays. Students can spend the night tasting the varieties of wine Meinhardt offers, share a cheese plate and have a night under the stars with that special someone.



Project Purple Ribbon fights domestic violence

BY ERINN WILLIAMS

The George-Anne staff

The D.I.M.E.S Fashion Organizations is bringing domestic violence awareness to Georgia Southern University through Project Purple Ribbon.

Project Purple Ribbon will be held from 7-8:30 p.m. on Thursday in the Williams Center Multipurpose Room and aims to celebrate those who have survived domestic abuse and honor those who did not.

"People often overlook Domestic Violence Awareness Month in October because it is also known for being Breast Cancer Awareness Month, but we as an organization are trying to bring awareness to another serious problem in our society," Jodi-Ann Simpson, senior public relations major and president of D.I.M.E.S, said.

The event will host free entertainment including the Spotlight Show Choir,



- Every **nine seconds** in the U.S. a woman is assaulted or beaten.
- Domestic violence is the **leading cause of injury to women**—more than car accidents, muggings and rapes combined.
- **1 in 4 women** will experience domestic violence during her lifetime.
- Most domestic violence incidents are **never** reported.
- Women experience **more than 4 million** physical assaults and rapes because of their partners, and men are victims of nearly 3 million physical assaults.

www.safehorizon.org
domesticviolencestatistics.org

Random Acts of Poetry and Candice Gary. Refreshments will be served.

A representative from The Safe Haven Women's Shelter of Bulloch County will also be speaking on domestic violence and sharing her story and the stories of others who have experienced it.

"Students should come to this event because domestic violence hits home with many people. I actually just lost my cousin to this type of situation last year. Through this event we are trying to educate Georgia Southern students on domestic violence and show them ways that they can help and prevent it along with what to do if you find yourself in that type of situation," Raven Taylor, senior business administration major and vice president of D.I.M.E.S, said.

Project Purple Ribbon is free but donations will be accepted to benefit Safe Haven Women's Shelter.

Samaya Sheffield, sophomore writing & linguistics major, said, "I think it's important to have events about such strong topics like domestic violence because everyday people are going through these life-threatening situations and need someone to stand up and support them, and I think these events will do a good job at providing us with the information that we need to take a stand against it."

Sarah Horne | The George-Anne



Want To Be
Kissable
This Flu Season?

Influenza Vaccination Clinics

No out of pocket costs for students covered by the following insurance companies:

Aetna; AmericaGroup [GA Medicaid]; BeechStreet; Cigna; Coventry/First Health/ CNN Southcare; Health Smart HPD; Humana Choice Care; Tricare; United HealthCare; United HealthCare-Student Resources [USG Student Health Insurance Program]; Wellcare [GA Medicaid].

\$5 for Students with no Health Insurance

\$5 for Faculty/Staff and Retirees
[Reimbursable if covered by USG Health Insurance]

Please bring your Insurance Card and Eagle ID

OCT. 3, 5-7 p.m.
Centennial Place Café

OCT. 8, 5-7 p.m.
Library Rm. 1300

OCT. 10, 3-7 p.m.
RAC Lobby

OCT. 15*
10-11 a.m. & 2-3 p.m.
Tent Event outside Health Services (inside if necessary)

OCT. 17, 2-5 p.m.
Russell Union Room 2080

OCT. 23*
10-11 a.m. & 2-3 p.m.
Health Services

NOV 6, 5-7 p.m.
Eagle Village Clubhouse

NOV 13, 5-7 p.m.
Southern Pines Clubhouse

NOV. 19*
10-11 a.m. & 2-3 p.m.
Health Services

***STUDENTS ONLY**

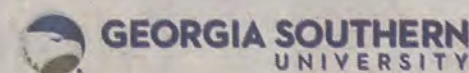

SPONSORED BY GEORGIA SOUTHERN UNIVERSITY HEALTH SERVICES
AND THE UNIVERSITY WELLNESS PROGRAM

'Captain Phillips' is definitely worth seeing

Film Review



BY ALEXANDRA MCCRAY

The George-Anne staff

Tom Hanks along with a no-name cast and director Paul Greengrass ("The Bourne Supremacy", "The Bourne Ultimatum", "United 93") work together brilliantly in "Captain Phillips" to create a movie that goes above and beyond the average action thriller.

Based on the Maersk Alabama hijacking in 2009, "Captain Phillips" emotionally draws in its audience through its realism and sense of desperation surrounding all those involved.

Hanks ("Forest Gump", "The Da Vinci Code") plays a slightly uptight yet honorable captain of a cargo ship that is destined to end up in Kenya to deliver supplies. But its route leads the crew around the horn of Africa, specifically near the pirate-filled waters of Somalia.

One thing that makes this heroic captain movie different from others is that as it opens, screenwriter Billy Ray ("Shattered Glass") makes

sure to show the audience not only what Phillips' everyday routine is like before he sets out on his journey, but also shows the poverty and desperation that surrounds the Somali pirates in their everyday lives.

After the few defense efforts and emergency calls that the cargo ships put out, the pirates fail. Armed and high on Khat, a shrub that is chewed and leaves its users temporarily feeling euphoric with an increased sense of alertness but afterward leads to irritability and depression, the pirates gain access to the ship surprisingly easy.

The band of four disheveled

Somali pirates are led by a smart and headstrong leader who is determined to lose everything in order to successfully pull off a major cargo hijacking, which he and his team

believe will lead to a pay day of millions.

"Captain Phillips" is refreshingly realistic and leaves audiences emotionally on the edge of their seats as the drama increases, and the question begins to loom, "Will anyone get out alive?"

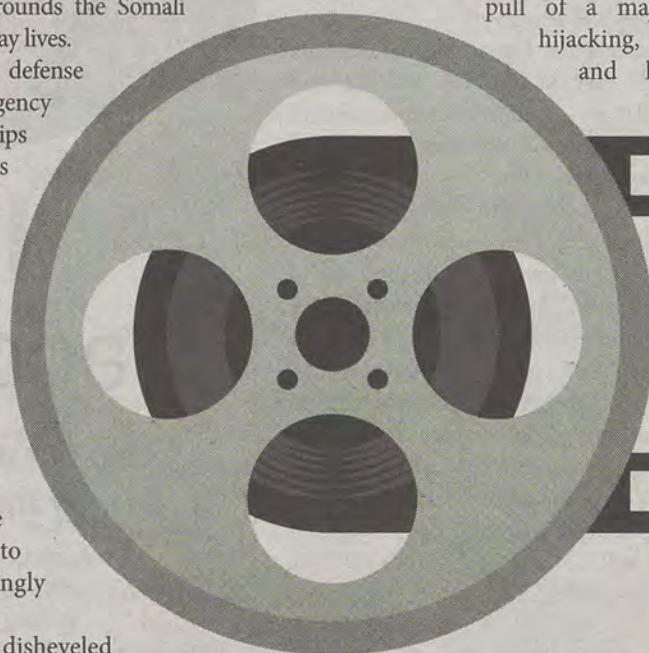

Alexandra Tobia | The George-Anne

CAMBRIDGE
@SOUTHERN
Now leasing for Fall 2014

\$0
DOWN
APPLY FREE
LIMITED TIME

Customize your lifestyle.
cambridge-southern.com

Hungarian folk dancers to visit PAC Thursday

Culture

BY MATT SOWELL

The George-Anne contributor

The Hungarian State Folk Ensemble will be giving students at Georgia Southern University a taste of what Hungarian culture is like.

The show is Thursday at 7:30 p.m. Tickets are \$10 and can be purchased in the Performing Arts Center lobby.

"When we were presented with the chance to bring this group in, we knew right away that it would be a unique opportunity for

the community," Stacie McDaniel, the house manager at the Georgia Southern PAC, said.

The group was established in 1951. Since then, it has travelled to 44 countries and performed in front of over seven-and-a-half million people.

"This is a group of performers that calls Hungary home and will be able to give the Georgia Southern and Statesboro communities a glimpse into a culture of traditions they might otherwise never get to experience. I love it when we're able to bring in international touring groups because they always bring such a fascinating flavor to our stage," McDaniel said.

The show will be in two acts and both will

feature traditional Hungarian dances that tell stories.

"I think that students will be surprised about how familiar the stories told by these dances will feel to them. From the history of a whole country, to simply meeting up with your girlfriends and gossiping about the guys you're interested in, there's something in these routines for everyone," McDaniel said.

"This show is considered to be one of the top touring groups in the world, so I am expecting an astounding show," Jennifer Zellner, PAC box office assistant, said. "I believe the Hungarian State Folk Ensemble

will give our audience a look at a traditional folkloric style performance and is sure to leave the viewer satisfied."

The dances will be accompanied by live music, courtesy of the Gypsy Orchestra.

"Personally, I'm really excited about the show because this is a culture that I didn't know much about before we started preparing for this performance," McDaniel said. "Americans don't always get a lot of formal education about the history of Eastern European countries, so I'm hoping to learn a little bit about this culture and its people and its traditions."



Courtesy of the PAC
The Performing Arts Center brings a variety of performances to Georgia Southern University's campus, including the Hungarian State Folk Ensemble. **Top:** The ensemble, an international touring group, will show Hungarian culture through dance and storytelling. **Left:** Hungarian dance couple performs traditional Hungarian dances. The Hungarian State Folk Ensemble will perform at the PAC this Thursday night. **Right:** The Hungarian State Folk Ensemble is a unique performance group to the GSU community.

CLASSIFIEDS

This page brought to you by Career Services
Explore • Experience • Excel

14 Tuesday, October 15, 2013

The George-Anne

Miscellaneous

Statesboro Main Street Farmer's Market Open every Saturday from 9am - 12:30pm through October. 2 East Main Street (in the Sea Island Bank parking lot). For more information on vendors and seasonal produce: www.statesborofarmersmarket.com

Housing

Female subleser needed for apartment in Hawthorne II during Spring 2014. Rent is \$250/month before utilities; Internet and cable are already paid for. Contact (678) 848-3526 for more information.

SUBLEASER WANTED: Huge unfurnished room in charming & spacious house. Two closets w/ built in shelving. hardwood floors. Connected Full bathroom. \$300 a month. Two other roommates so utilities are split 3 ways. contact Lorenzo Soler @ (912)506-4556 or at ls04113@georgiasouthern.edu

Housing

Subleasing garden district apartment. One room available in 3 bedroom 3/4 furnished flat. \$380a month with a small subleasing fee of \$150. This fee is one time fee! Everything is furnished accept living room. The bedroom, kitchen, and bathroom are fully furnished. Everything is inclusive. The lease is up in aug. 2014 . 1 month rent is free if called or contacted by email before Feb 2014 . contact me at 7069888232 (jimmy gray) or email me at diesaltruck2006@gmail.com Serious inquiries only

Sublease Available for Spring!! The Connection of Statesboro. 4 BR/4 BA. Second floor apartment right next to basketball court and pool. Clean. Two male roommates, one empty room still available. Rent is \$444/month, utilities included. Call/text: 912-237-4491 Email: ws01114@georgiasouthern.edu

Jobs

Nanny needed for 3 energetic kids (7,5,3) at least 2 to 3 afternoons a week, some weekends, family lives 15 miles outside of Statesboro. Email school schedule and resume to southernntan@gmail.com

For Sale

2008 Volkswagen (VW) Passat Komfort Sedan 4D. \$12,000 negotiable. Mileage: 40,500, Blue Exterior Black Leatherette Interior One Owner. Email designjj@gmail.com or call at 912-478-2343

Will proof papers for grammar, punctuation, spelling, sentence structure. Must have enough lead time to do job efficiently. Reasonable rates. Email auntre01@gmail.com.

2 AKC REGISTERED ENGLISH BULLDOGS FOR FREE.. IF INTERESTED CONTACT: f123.anderson@gmail.com

Jobs

BARTENDERS WANTED!!! \$250 a day potential. No experience necessary. Training Provided. Age 18+ OK Call 1-800-965-6520 ext 296.

For Sale

FOOTBALL TICKETS FOR SALE: Sept 28 GSU vs Chattanooga -- 2 tickets for sale at \$20 each, Section G, Row 15, Seats 3 and 4. Tickets also available for Oct 12(The Citadel), Nov 2 (Furman), and Nov 9 (Western Carolina). Email: sgallemore@georgiasouthern.edu or aimao@georgiasouthern.edu.

four - GSU vs APP STATE football tickets | \$35 each, Section 109, Row M, Seats 24-27 | call 912-478-8628 or email snelson@georgiasouthern.edu

Brand new Ray Ban Wayfarer 2140 black sunglasses. \$70
Text 404-834-2123 if interested

Housing

Lease for spring semester in the Forum at Statesboro: 3 bedroom 3 bathroom, 475 a month no utility overages Indoor basketball court. Contact Randall 404-643-8097 email: rh01900@georgiasouthern.edu

Miscellaneous

Ahoy Sailor! Interested in sailing? In search of students, faculty, and staff to help start and be involved in a GSU Sailing Club. Contact gsusailingclub@gmail.com for more information.

For Sale

Moderately used EVO FX -25 Motorized Treadmill, in excellent condition Multiple programming for varied routines, speed and incline. Easily folded and stored. \$750.00 | Call 912-587-7338 | e-mail: gb00812@georgiasouthern.edu

Green North Face shirt medium \$10 | Navy blue Guy Harvey long sleeve- like new- size small \$17 | Orange Patagonia t-shirt size small \$14 | Aqua colored Southern Tide shirt small/fits like a medium \$20 | Yellow Guy Harvey t-shirt small \$14 | Polo oxford button down long sleeve blue with stripes size small \$24 | All in excellent condition. Text 404-834-2123 or email mcce@comcast.net if interested.

Hawthorne

912.681.1166
www.hendleyproperties.com

2 bedroom flat
\$350
month per person

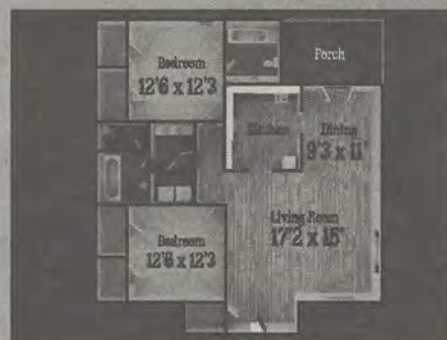

Have something
to get rid of?

Make some money by putting it in
The George-Anne's classifieds ads.

FREE
to students,
faculty and staff!

PUZZLES&COMICS

www.thegeorgeanne.com

Tuesday, October 15, 2013 15

Los Angeles Times Daily Crossword Puzzle

Edited by Rich Norris and Joyce Lewis

ACROSS

- 1 The grand concert one has 47 strings
- 5 Teen hangout
- 9 poll
- 14 French possessive
- 15 Chills and fever
- 16 "The Voice" judge Green
- 17 Holdup device?
- 18 Party person
- 19 Communications device
- 20 Question cards in their cups?
- 23 Response to "Are you serious?"
- 24 Gardner of old films
- 25 Wow
- 28 Burden beasts of burden?
- 32 Western landscape feature
- 36 Vessel designation
- 37 Weigh station visitors
- 38 New Testament book
- 39 Variable-yield investment option
- 42 Passed-down tales
- 43 CBS newswoman O'Donnell
- 45 Summer baby
- 46 Termini
- 47 Stumble over plumbing gunk?
- 51 Brahms's A?
- 52 View from Marseille
- 53 To-do
- 58 Proper sort ... or a cry upon solving each of this puzzle's theme answers?
- 62 Canceled a reservation, maybe
- 64 Waikiki's whereabouts
- 65 Yankee great, familiarly, with "The"
- 66 Window box bloom
- 67 "Exodus" novelist
- 68 US Open stadium

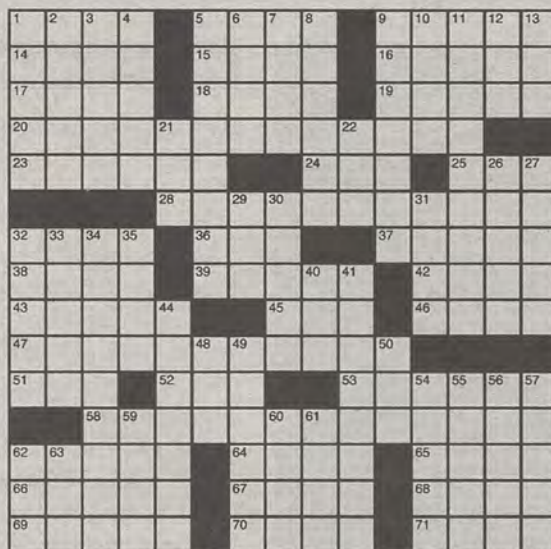

By Elizabeth A. Long

- 69 Post with carvings
- 70 Passé demo item
- 71 Scholarship factor

DOWN

- 1 "Satisfied now?"
- 2 " friend unbosoms freely ...": Penn
- 3 Innkeeper's offerings
- 4 Longstocking of kiddie lit
- 5 Hawaiian for "very strong"
- 6 All atwitter
- 7 Thick with vegetation
- 8 Super-harmful
- 9 Serious argument components
- 10 Colorful duck
- 11 North Pacific sockeye
- 12 Woodcutter Baba
- 13 Seek favor with
- 21 Feasts on
- 22 Garden outcast
- 26 Strange and then some
- 27 Pluralizers
- 29 Society honoree
- 30 Waggish
- 31 Ubangi tributary

Last Edition's Puzzle Solved

S	M	A	R	T	S		P	P	D		P	E	A						
H	O	L	I	S	T		E	L	E	A		A	N	G					
O	R	A	N	G	E		B	A	C	K	A	T	Y	A					
W	A	R	S	A	W		P	A	C	T		T	S	A	R				
E	L	M	E	R		O	N	E	I	O	T	A							
D	E	S		P	O	T		S	N	O	W	J	O	B					
							P	O	P		K	O	A	L	A				
O	I	L		A	S	K	A	W	A	Y		K	E	Y					
A	D	A	I	R		W	I												
K	I	L	D	A	R	E		D	R	U		C	S	T					
							A	L	L	E	G	R	O		P	A	L	E	O
M	L	L	E		D	R	A	W	A	B	L	A	N	K					
A	A	A	R	A	T	E	D		R	E	F	U	S	E					
K	I	N		S	E	T	S		M	A	I	D	E	N					
E	N	D		P	A	S			S	T	E	E	D	S					

- 32 Minister's quarters
- 33 Culprit in some food recalls
- 34 Severe
- 35 "Without delay!"
- 40 "The Matrix" hero
- 41 Spot for one in disfavor
- 44 Rebus puzzle staple
- 48 Outlaw Kelly
- 49 Shriek
- 50 Brillo alternative
- 54 "You've got to be kidding"
- 55 Grace
- 56 Nourishment for un bébé
- 57 Put in a request
- 59 Department of northern France
- 60 Lipinski with a gold medal
- 61 Beat
- 62 Well-put
- 63 Confucian path

ONCE UPON A TIME ON A SPACE STATION, THERE LIVED A LAD NAMED WINKY.



ONE DAY, A WORMHOLE GREW INSIDE THE STATION.



HE CLIMBED UP THE WORMHOLE. AND AT THE TOP OF THE WORMHOLE THERE LIVED ...



A GIANT!

WE JUST MET AND I'VE ALREADY BEEN STEREOTYPED.



NEXT: A BIG PROBLEM

Calamities of Nature by Tony Piro

WHAT'S THE PATCH FROM? OH, I GAVE BLOOD TODAY.



THAT'S GREAT! IT'S NICE TO HEAR THAT YOU'RE GIVING SOMETHING BACK. ACTUALLY, I JUST DID IT SO I CAN GET WASTED EASIER.



IRONICALLY, FERD BEING PASSED OUT COULD BE THOUGHT OF AS AN ACT OF CHARITY TO THE WORLD...



Sudoku

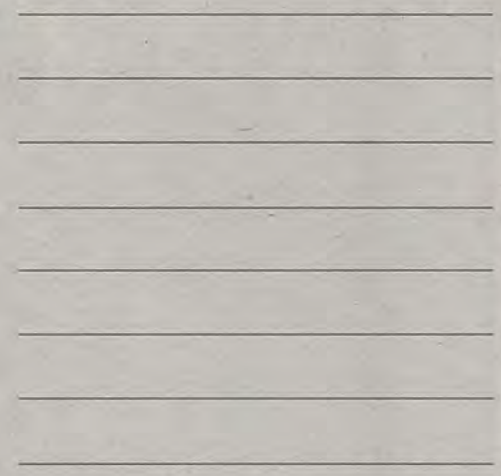

THE GEORGE-ANNE

<http://www.thegeorgeanne.com>

see more online



Elon to provide tough road test for GSU



Senior forward Witt Carlisle (9) outleaps a defender to deliver a header. Carlisle and the Eagles will try to produce offense against the stingy defense of Elon University.

Men's Soccer (4-7)

BY TREVOR MCNABOE

The George-Anne staff

In a season with more downs than ups, Georgia Southern University men's soccer team will take on one of its toughest opponents of the season as it plays Elon University tonight.

The Eagles are coming off a loss at home to Georgia State University by a score of 2-1. GSU is currently on a three-game losing streak, and during this streak it has been outscored 7-2.

The Phoenix on the other hand is 9-2-1 and coming off an in-conference loss to Wofford College by a tally of 2-1.

Elon had success at home this year as it has gone 4-1 and outscored opponents 6-2.

On the flip side, GSU has struggled away from Eagle Field going 2-3 despite outscoring opponents by a 5-4 goal total.

The Phoenix has bested the Eagles as of late, winning six of the last eight matchups with the most recent matchup being in the Southern Conference semifinals last season, which resulted in a 1-0 win for Elon.

The Phoenix, as a team, has scored 21 goals this season while averaging 1.75 goals. The offense runs through three players for Elon: junior forward Jason Waterman, who has six goals and five assists, sophomore midfielder James Brace, who has six goals and 12 points and senior midfielder Matt Wescoe, with three goals and seven assists.

In the two games against the Eagles last season, Waterman was able to score two of the team's five total goals, while Wescoe added a goal of his own and one assist in route to the Phoenix sweeping GSU last season.

For the Eagles, senior forward Witt Carlisle has provided the scoring spark for GSU as he leads the team with four goals and two assists. Last season, Carlisle scored against the Phoenix in a 4-3 Eagle loss.

GSU will have a challenge on its hands as Elon has only given up nine goals this season, which averages out to 0.75 goals per game.

Both keepers have had stellar seasons so far as Phoenix junior goalkeeper Nathan Dean has recorded 52 saves this year for a .852 save percentage. Comparable to Eagle senior goalkeeper Neal Bates with 67 saves and a .807 save percentage.

GSU will take on Elon on the road at 7 p.m. in a SoCon matchup.

Heather Yeomans | The George-Anne



Sophomore midfielder Cori Dulmage (33) kicks the ball before Appalachian State University freshman forward Aubrey Fletcher (36) blocks it. With the victory, the Eagles climbed back to .500 in the conference.

Courtney Bonacci | The George-Anne

Eagles avenge loss

Women's Soccer (4-7-2)

BY CHASE DAVIS

The George-Anne contributor

Georgia Southern University women's soccer (4-7-2, 2-2-1 Southern Conference) powered past The Citadel (3-8-2, 1-5 SoCon) Sunday by a score of 3-2 on a late-game goal by senior forward Alex Murphy.

The win avenges a 4-2 defeat at the hands of the Bulldogs last season and also gave GSU a .500 record in the SoCon.

"It was a very hard-fought game, very physical," head coach Brian Dunleavy said in a news release.

After a rather slow beginning to the game, sophomore forward Nora El-Shami drew first blood in the 33rd minute, notching her third goal of the season to put the Eagles up 1-0.

Both offensive attacks remained silent through halftime until the 68th minute, when The Citadel's senior forward Nicole

Levermann knotted up the score at 1-1.

The Eagles answered 10 minutes later, with sophomore forward Caitlin Tongco tapping in a botched save by The Citadel's freshman goalkeeper Naomi Carter. Murphy picked up the assist.

The Bulldogs rallied back to tie it at two apiece late on a free kick. Murphy booted the game winner just 20 seconds later, sealing the game for the Eagles.

"Defensively, we were put under a lot of pressure particularly in the second half because it was very windy, and they were playing long balls to try to get in behind us," Dunleavy said in a news release. "Our back four had to battle for headers the entire game. We were clinical with our finishing, and scored some excellent goals. Three points on the road is massive."

The Eagles will return home to take on Elon University Friday and the University of North Carolina at Greensboro on Sunday for senior day.

GSU cleans up its game with two sweeping wins

Volleyball (17-3)

BY KAITLYN GLENN

The George-Anne contributor

After losing to Furman University and ending a nine-match winning streak, the Georgia Southern University volleyball team (17-3, 5-1 Southern Conference) came back with a vengeance and got two more wins under its belts.

The Eagles took on their conference opponents, the University of North Carolina at Greensboro Spartans (10-9, 3-3 SoCon) and the Elon University Phoenix (12-10, 3-3 SoCon).

On Friday against UNCG, junior middle Kym Coley recorded 11 kills, four blocks and hit .348. Junior outside hitter Jamie DeRatt also posted 10 kills and 16 digs helping the Eagles pull out a tough win. Senior outside hitter Nicole Jeschelnik was the third Eagle to record double-digit kills, with 10.

"We played really well and our passing was good. It helped keep the defense honest and made it easier for (our) offense to put away balls," Coley said.

Even though the Eagles swept the match (25-21, 25-23, 25-23), the Spartans stood their ground and made it a good game.

Saturday afternoon against Elon, sophomore setter Katalin Minnerly posted 33 assists, seven digs and two blocks, while sophomore libero Alexandra Beecher had a match-high 12 digs. DeRatt posted 10 kills and six digs and sophomore right side Katie Bange led the Eagles in kills with 11.

GSU took the first set 25-10 by hitting .444. In the second set the Phoenix pushed GSU to the edge, but the Eagles came back and won a close set 26-24. In the third set the Eagles had a nice cushion and took the set 25-16, winning the match.

"I think we played well, we took care of business I guess since we beat them, both the teams in threes," Minnerly said.

With a tough schedule this season, the Eagles have been working hard to get on top and stay there.

"We're just working individually. As long as we all do our parts, we'll work well together," Coley said.

After earning these two conference wins, the Eagles shot back up to the number one seed in the SoCon over Furman, which holds a 9-8 record overall and a 5-1 SoCon record.

This Friday, the Eagles will be back on the road taking on the Appalachian State University Mountaineers.



Drew Heimlich | The George-Anne

Senior libero Lauren LaRocque (4) focuses on going for an ace. LaRocque played in all six sets and recorded eight digs over the weekend.



Andy Morales | The George-Anne

Head football coach Jeff Monken was able to lead an injury-riddled team to a win over The Citadel. **Top:** Monken gets the team focused for the game. **Bottom:** Monken looks on prior to the start of the game, wearing patches on his shirt for Military Appreciation Day.

REVENGE, from page 1

Ellison put GSU ahead for good with a four-yard touchdown run with 1:59 left in the game.

The offense scored in crunch time, but it was the defense that played an inspired game compared to last week's effort against Samford University. The Citadel came into the game with the second-best rushing attack in the Southern Conference, but GSU held the Bulldogs 100 yards below their season average of 267.

"Coming into the game, we really wanted to lessen the amount of yards put up on us," freshman defensive lineman Rafael Hardee said.

The Eagles gave up one big play over 50 yards against The Citadel compared to four last week. The Citadel senior quarterback Ben Dupree capitalized on a blown assignment and sprinted 73 yards for a score on the Bulldogs second drive of the game.

The defense allowed 166 yards on the ground, but if not for that one defensive breakdown GSU would have held the potent Bulldogs to just 93 rushing yards. The Citadel converted just one third down the whole game compared to seven for GSU.

The Citadel had no answer for the Eagles offense, particularly senior quarterback Jerick McKinnon. McKinnon was forced

into action at fullback with all the injuries GSU is dealing with. He credited a solid week of preparation for his 198 rushing yards and two touchdowns.

"The offensive line did a great job of just making things easy for me," McKinnon said. "(offensive coordinator Brent Davis) Coach Davis, (assistant head coach/quarterbacks coach Mitch Ware) coach Ware and (head coach Jeff Monken) Monken all did a great job of helping me get ready to play b-back this week."

GSU won the game with weapons missing all over the field, but Monken still expects his team to come out and compete hard every week. GSU overcame the injuries this week and the fan base will expect the same against Appalachian State University in two weeks.

"I'm not going to sit and make excuses and say well, we don't have three of our starting offensive lineman, which we didn't today. We don't have our best pass rusher Javon Mention, which we didn't today," Monken said. "We're down to our fifth string b-back, but I'm going to do whatever we need to help our team win."

The Eagles will have their second and final bye week this week before facing off against current SoCon and future Sun Belt Conference rival Appalachian State University next Saturday in Boone, N.C. at 3:30 p.m.

Pair of Eagles earn weekly awards

BY WILL CHENEY

The George-Anne staff

Following Georgia Southern University's win over The Citadel this past weekend, a pair of Eagle players earned Southern Conference honors.

Senior quarterback Jerick McKinnon, who was seen starting at fullback on Saturday, earned SoCon Offensive Player of the Week. McKinnon totaled 198 yards on the ground with two touchdowns and he also accounted for a successful two-point conversion with a pass to redshirt sophomore running back Devin Scott.

McKinnon recorded 59 of his 198 yards on the final scoring drive for the Eagles, which helped set up the game-winning touchdown. After Saturday, McKinnon, who now has 38 career rushing touchdowns, claimed the eight spot on the all-time career rushing touchdown list for GSU.

"Being under the gun with Jerick back there with me, it really helped me," redshirt

freshman quarterback Kevin Ellison said. "The help from the offensive side, defensive side and coaching staff just help me out a lot."

While McKinnon nabbed the Offensive Player of the Week honors, Ellison received SoCon Freshman of the Week honors. Ellison, who got the nod to start against The Citadel last Saturday, posted strong numbers for the second straight week.

Ellison completed seven of 10 pass attempts for 138 yards and gained a career-high 135 yards and a touchdown on the ground. This came off his performance the previous week against Samford University when he was a perfect seven of seven through the air for 140 yards and two touchdowns, both to redshirt junior running back Tray Butler.

"During practice, Kevin did a good job all week and we were just making sure everything was on the same page and he did his part," McKinnon said. "A huge shout out to the offensive line. They played great and were fighting all game."



Andy Morales | The George-Anne



Brandon Warnock | The George-Anne

Freshman quarterback Kevin Ellison and senior quarterback Jerick McKinnon earned Southern Conference Player of the Week honors. **Left:** McKinnon (1) runs past a group of defenders. **Right:** Ellison (4) picks up yards on the ground.

LEADERSHIP FOR STATESBORO'S FUTURE



JAN
MOORE
for
★**MAYOR**★

Paid for by the campaign to elect Jan Moore

Georgia Southern Soccer



Friday, October 18th, 7 pm
-Georgia Southern vs. Elon
*Ladies Night!

Saturday, October 19th, 7 pm
-Georgia Southern vs. App State
*#TrueBlue Out!

Sunday, October 20th, 2 pm
-Georgia Southern vs. UNCG
*Senior Day!

TRUE BLUE
GEORGIA SOUTHERN

YOUR SCHOOL. YOUR LIFE. YOUR MAGAZINE.

REFLECTOR

magazine

